

9	50-007-009	0.63"	15.9 mm	0.81"	20.6 mm
8	50-007-008	0.81"	20.6 mm	0.94"	23.8 mm
7	50-007-007	0.94"	23.8 mm	1.06"	27.0 mm
6	50-007-006	1.06"	27.0 mm	1.19"	30.2 mm
5	50-007-005	1.19"	30.2 mm	1.31"	33.3 mm
4	50-007-004	1.31"	33.3 mm	1.44"	36.5 mm
3	50-007-003	1.44"	36.5 mm	1.69"	42.9 mm
2	50-007-002	1.69"	42.9 mm	1.94"	49.2 mm
1	50-007-001	1.94"	49.2 mm	2.19"	55.6 mm
ITEM	PART NO.	INCH	MM	INCH	MM
		MIN. PIN DIA.		MAX. PIN DIA.	
PIN BUSHINGS					

27	See Tool Chart	Pin Assembly Tool
26	50-008-002	Pin Adapter Holder
25	50-008-001	Assembly Tool
24	B2867	Backing-Side Cam-Lock Adapter
23	B2866	Cylinder-Side Cam-Lock Adapter
ITEM	PART NO.	DESCRIPTION
ADAPTERS		

19	25553	2.25"	57.2 mm	2.38"	60.3 mm
18	25501	2.00	50.8 mm	2.25"	57.2 mm
17	25551	1.81"	46.0 mm	2.00	50.8 mm
16	25548	1.69"	42.9 mm	1.81"	46.0 mm
15	25547	1.56"	39.7 mm	1.69"	42.9 mm
14	25500	1.44"	36.5 mm	1.56"	39.7 mm
13	25499	1.31"	33.3 mm	1.44"	36.5 mm
12	25498	1.19"	30.2 mm	1.31"	33.3 mm
11	200281	0.87"	22.2 mm	1.19"	30.2 mm
10	25503	0.76"	19.4 mm	0.87"	22.2 mm
ITEM	PART NO.	INCH	MM	INCH	MM
		MIN. PIN DIA.		MAX. PIN DIA.	
FORCING PINS					

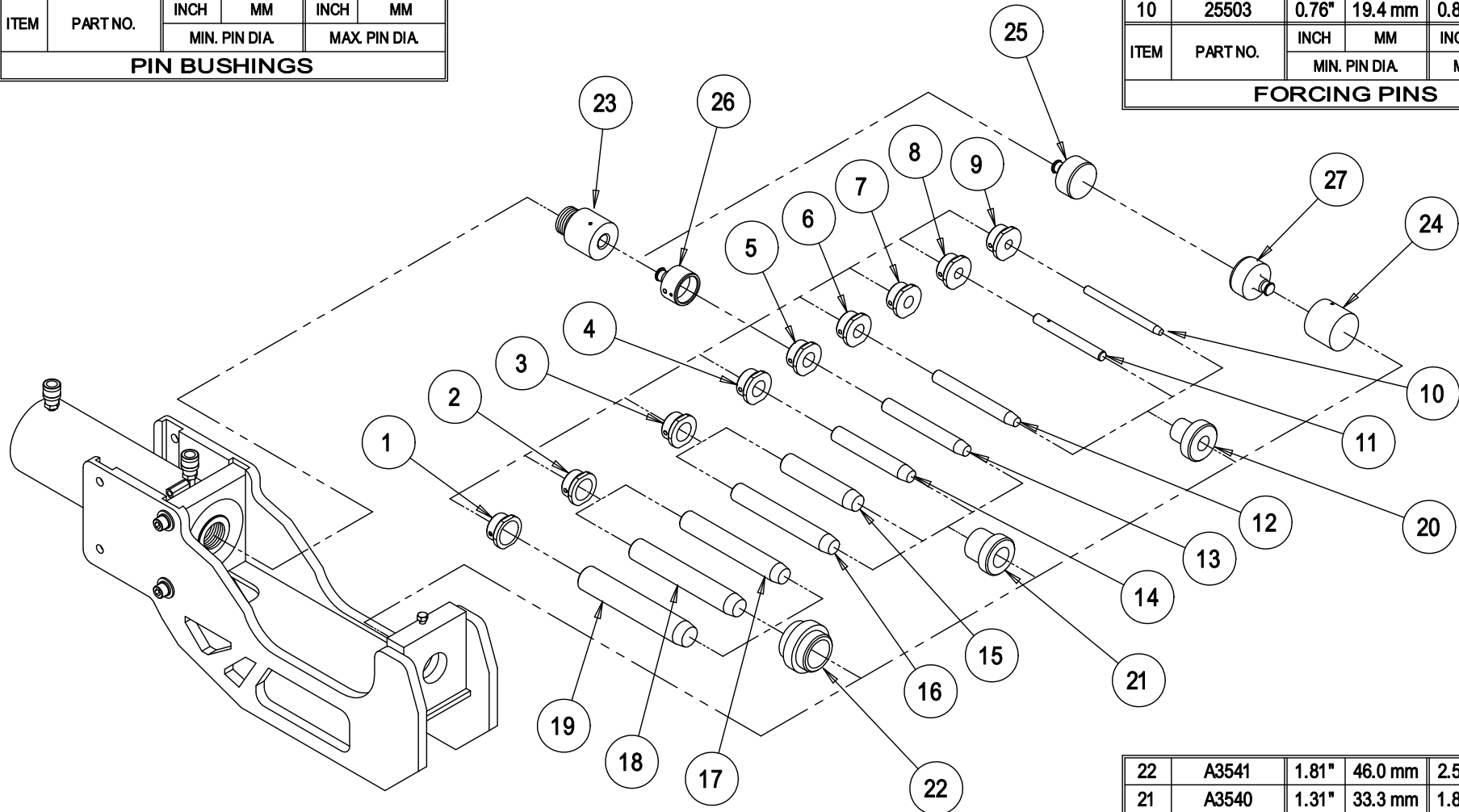

FP100 Tooling

22	A3541	1.81"	46.0 mm	2.56"	65.1 mm
21	A3540	1.31"	33.3 mm	1.81"	46.0 mm
20	A3539	0.63"	16.0 mm	1.31"	33.3 mm
ITEM	PART NO.	INCH	MM	INCH	MM
		MIN. PIN DIA.		MAX. PIN DIA.	
BACKING BUSHINGS					

WTC Machinery
100 Ton Field Press

Make	Model	Comments	Type	Pin Dimensions			Disassembly Tooling			Assembly Tooling	
				Dia.	Pitch	Length	Pin Adapter	Forcing Pin	Backing Bushing	Pin Adaptor	PAT
CASE	350		FLUSH	0.993	5.22	5.875	50-007-006	200281	A3539	50-007-007	915068
CASE	400		FLUSH	0.993	5.22	5.875	50-007-006	200281	A3539	50-007-007	915068
CASE	420		FLUSH	0.993	5.22	5.875	50-007-006	200281	A3539	50-007-007	915068
CASE	450			1.0625	5.375	5.875	50-007-006	200281	A3539	50-007-007	915225
CASE	450		FLUSH	1.187	5.38	5.75	50-007-006	25498	A3540	50-007-006	915066
CASE	500		FLUSH	0.993	5.22	5.875	50-007-006	200281	A3539	50-007-007	915068
CASE	550	JAK001396 8 & DN	SEALED	1.129	6.457	5.998	50-007-006	200281	A3540	50-007-006	915066
CASE	550		SEALED	1.129	6.575	6.29	50-007-006	200281	A3540	50-007-006	915144
CASE	550		SALT	1.129	6.575	6.29	50-007-006	200281	A3540	50-007-006	915144
CASE	560		FLUSH	0.993	5.22	5.875	50-007-006	200281	A3539	50-007-007	915068
CASE	600			1.0625	5.375	5.875	50-007-006	200281	A3539	50-007-007	915225
CASE	650		SEALED	1.318	7.224	6.734	50-007-005	25499	A3540	50-007-005	915011
CASE	650		SALT	1.318	7.224	6.735	50-007-005	25499	A3540	50-007-005	915158
CASE	700	S/N 7070351 &	RECESSED	1.248	6.5	6.25	50-007-005	25498	A3540	50-007-005	915056
CASE	750		RECESSED	1.375	6.94	6.25	50-007-004	25499	A3540	50-007-004	915069
CASE	800		RECESSED	1.248	6.5	6.25	50-007-005	25498	A3540	50-007-005	915056
CASE	850		SEALED	1.375	6.94	6.25	50-007-004	25499	A3540	50-007-004	915009

WTC Machinery
100 Ton Field Press

CASE	1000	HD	RECESSED	1.375	6.94	6.25	50-007-004	25499	A3540	50-007-004	915069
CASE	1000		RECESSED	1.248	6.5	6.25	50-007-005	25498	A3540	50-007-005	915056
CASE	1000		SEALED	1.375	6.94	6.25	50-007-004	25499	A3540	50-007-004	915009
CASE	1150		RECESSED	1.375	6.94	6.25	50-007-004	25499	A3540	50-007-004	915069
CASE	1150		SEALED	1.375	6.94	6.25	50-007-004	25499	A3540	50-007-004	915009
CASE	1150		SEALED	1.375	6.94	6.25	50-007-004	25499	A3540	50-007-004	915011
CASE	1450		SEALED	1.752	9.075	8.02	50-007-002	25547	A3541	50-007-002	915070
CASE	1550		SEALED	1.753	9.06	8.02	50-007-002	25547	A3541	50-007-002	915226
CASE	1550		SALT	1.753	9.06	8.02	50-007-002	25547	A3541	50-007-002	915006
CASE	1150B		SEALED	1.5	8.1	6.678	50-007-003	25500	A3540	50-007-003	915067
CASE	1150D	7310051 & PRIOR	SEALED	1.44	8.11	6.678	50-007-004	25500	A3540	50-007-004	915052
CASE	1150D	7310051 & PRIOR	SALT	1.44	8.11	6.678	50-007-004	25500	A3540	50-007-004	915052
CASE	1150E		SALT	1.44	8.11	6.678	50-007-004	25500	A3540	50-007-004	915052
CASE	1150E		SEALED	1.44	8.11	6.678	50-007-004	25500	A3540	50-007-004	915052
CASE	1155D	7311001 & PRIOR	SALT	1.44	8.11	6.678	50-007-004	25500	A3540	50-007-004	915052
CASE	1155D	7311001 & PRIOR	SEALED	1.44	8.11	6.678	50-007-004	25500	A3540	50-007-004	915052
CASE	1155E		SALT	1.44	8.11	6.678	50-007-004	25500	A3540	50-007-004	915052
CASE	1155E		SEALED	1.44	8.11	6.678	50-007-004	25500	A3540	50-007-004	915052
CASE	1450B		SEALED	1.752	9.075	8.02	50-007-002	25547	A3541	50-007-002	915070

WTC Machinery
100 Ton Field Press

CASE	1450B	S/N 8383001 &	SEALED	1.753	9.06	8.02	50-007-002	25547	A3541	50-007-002	915226
CASE	1450B		SALT	1.753	9.06	8.02	50-007-002	25547	A3541	50-007-002	915006
CASE	1455B		SEALED	1.752	9.075	8.02	50-007-002	25547	A3541	50-007-002	915070
CASE	1455B	S/N 8480001 &	SEALED	1.753	9.06	8.02	50-007-002	25547	A3541	50-007-002	915226
CASE	1455B		SALT	1.753	9.06	8.02	50-007-002	25547	A3541	50-007-002	915006
CASE	310G		FLUSH	0.993	5.22	5.875	50-007-006	200281	A3539	50-007-007	915068
CASE	350B		SEALED	0.994	5.219	5.875	50-007-006	200281	A3539	50-007-007	915224
CASE	450A	S/N 3030801 &	SEALED	1.25	6.54	6	50-007-005	25498	A3540	50-007-005	915069
CASE	450B		SEALED	1.25	6.54	6	50-007-005	25498	A3540	50-007-005	915069
CASE	450C		SALT	1.129	6.46	6	50-007-006	200281	A3540	50-007-006	915046
CASE	450C		SEALED	1.129	6.457	5.998	50-007-006	200281	A3540	50-007-006	915066
CASE	455C		SALT	1.129	6.46	6	50-007-006	200281	A3540	50-007-006	915046
CASE	550E		SEALED	1.129	6.575	6.29	50-007-006	200281	A3540	50-007-006	915144
CASE	550E		SALT	1.129	6.575	6.29	50-007-006	200281	A3540	50-007-006	915144
CASE	550G	w/ Floating Bushing	SEALED	1.129	6.575	6.29	50-007-006	200281	A3540	50-007-006	915144
CASE	850B		SEALED	1.375	6.94	6.25	50-007-004	25499	A3540	50-007-004	915009
CASE	850D		SALT	1.318	7.22	6.25	50-007-005	25499	A3540	50-007-005	915011
CASE	850D		SEALED	1.375	6.94	6.25	50-007-004	25499	A3540	50-007-004	915011
CASE	850D		SEALED	1.318	7.224	6.734	50-007-005	25499	A3540	50-007-005	915011

WTC Machinery
100 Ton Field Press

CASE	850D		SALT	1.318	7.224	6.735	50-007-005	25499	A3540	50-007-005	915158
CASE	850E	AFTER 4-1-89	SEALED	1.318	7.224	6.734	50-007-005	25499	A3540	50-007-005	915011
CASE	850E	AFTER 4-1-89	SALT	1.318	7.224	6.735	50-007-005	25499	A3540	50-007-005	915158
CASE	850G		SEALED	1.318	7.224	6.734	50-007-005	25499	A3540	50-007-005	915011
CASE	850G		SALT	1.318	7.224	6.735	50-007-005	25499	A3540	50-007-005	915158
CASE	850H		SEALED	1.318	7.224	6.734	50-007-005	25499	A3540	50-007-005	915011
CASE	850H		SALT	1.318	7.224	6.735	50-007-005	25499	A3540	50-007-005	915158
CASE	850K		SEALED	1.318	7.224	6.734	50-007-005	25499	A3540	50-007-005	915011
CASE	850K		SALT	1.318	7.224	6.735	50-007-005	25499	A3540	50-007-005	915158
CASE	855D		SALT	1.318	7.22	6.25	50-007-005	25499	A3540	50-007-005	915011
CASE	855D		SEALED	1.375	6.94	6.25	50-007-004	25499	A3540	50-007-004	915011
CASE	855D	AFTER 4-1-89	SEALED	1.318	7.224	6.734	50-007-005	25499	A3540	50-007-005	915011
CASE	855D	AFTER 4-1-89	SALT	1.318	7.224	6.735	50-007-005	25499	A3540	50-007-005	915158
CATERPILLAR	30		RECESS	1.314	7	6.735	50-007-005	25499	A3540	50-007-005	915011
CATERPILLAR	215	w/ 9/16 BOLT	SEALED	1.315	6.37	6.735	50-007-005	25499	A3540	50-007-005	915089
CATERPILLAR	215	w/ 5/8 BOLT	SEALED	1.314	7.22	6.735	50-007-005	25499	A3540	50-007-005	915011
CATERPILLAR	219		SEALED	1.442	8.12	7.48	50-007-004	25500	A3540	50-007-004	915052
CATERPILLAR	225	EXC	SEALED	1.314	7.22	6.735	50-007-005	25499	A3540	50-007-005	915011
CATERPILLAR	225		SEALED	1.252	9.06	7.984	50-007-005	25498	A3540	50-007-005	915003

WTC Machinery
100 Ton Field Press

CATERPILLAR	227		SEALED	1.252	9.06	7.984	50-007-005	25498	A3540	50-007-005	915003
CATERPILLAR	229		SEALED	1.252	9.06	7.984	50-007-005	25498	A3540	50-007-005	915003
CATERPILLAR	235	EXC	SEALED	1.252	9.06	7.984	50-007-005	25498	A3540	50-007-005	915003
CATERPILLAR	235		SEALED	1.877	9.88	8.5	50-007-002	25551	A3541	50-007-002	915012
CATERPILLAR	245	EXC	SEALED	2.253	11.259	10.25	50-007-001	25553	A3541	N/A	915005
CATERPILLAR	311	EXC	SEALED	1.321	7.01	6.75	50-007-005	25499	A3540	50-007-005	915059
CATERPILLAR	312	EXC	SEALED	1.321	7.01	6.75	50-007-005	25499	A3540	50-007-005	915059
CATERPILLAR	315	EXC	SEALED	1.442	8.15	7.48	50-007-004	25500	A3540	50-007-004	915140
CATERPILLAR	317	EXC	SEALED	1.442	8.15	7.48	50-007-004	25500	A3540	50-007-004	915140
CATERPILLAR	320	EXC	SEALED	1.442	8.15	7.48	50-007-004	25500	A3540	50-007-004	915140
CATERPILLAR	322	EXC	SEALED	1.442	8.15	7.48	50-007-004	25500	A3540	50-007-004	915140
CATERPILLAR	325	EXC	SEALED	1.654	9.055	8	50-007-003	25547	A3541	50-007-003	915141
CATERPILLAR	330	EXC	SEALED	1.811	9.665	8.5	50-007-002	25551	A3541	50-007-002	915015
CATERPILLAR	345	EXC	SEALED	2.003	11.438	8.5	50-007-001	25551	A3541	50-007-001	915142
CATERPILLAR	350		SEALED	2.003	11.438	9	50-007-001	25551	A3541	50-007-001	915001
CATERPILLAR	365	EXC	SEALED	2.253	12.244	10.25	50-007-001	25553	A3541	N/A	915139
CATERPILLAR	375	EXC	SEALED	2.253	12.244	10.25	50-007-001	25553	A3541	N/A	915139
CATERPILLAR	561	PIPELAYER	SEALED	1.442	8.125	6.906	50-007-004	25500	A3540	50-007-004	915009
CATERPILLAR	571		SEALED	1.752	9.875	7.984	50-007-002	25547	A3541	50-007-002	915012

WTC Machinery
100 Ton Field Press

CATERPILLAR	572		SEALED	1.752	9.875	7.984	50-007-002	25547	A3541	50-007-002	915012
CATERPILLAR	572		SEALED	1.877	9.88	8.5	50-007-002	25551	A3541	50-007-002	915012
CATERPILLAR	578	PIPELAYER	SALT	1.88	9.88	8.5	50-007-002	25551	A3541	50-007-002	915006
CATERPILLAR	578		PPR	1.878	9.65	8.5	50-007-002	25551	A3541	50-007-002	A3326-001
CATERPILLAR	583		SEALED	1.752	11.438	7.985	50-007-002	25547	A3541	50-007-002	915013
CATERPILLAR	589		PPR	2	10.77	9	50-007-001	25551	A3541	50-007-001	A3326-002
CATERPILLAR	589	PIPELAYER	SALT	2	11.437	9	50-007-001	25551	A3541	50-007-001	915093
CATERPILLAR	594		SEALED	2.252	12.25	10.25	50-007-001	25553	A3541	N/A	915005
CATERPILLAR	931		SEALED	1.129	6.156	6.125	50-007-006	200281	A3540	50-007-006	915004
CATERPILLAR	931		SALT	1.126	6.161	6.125	50-007-006	200281	A3540	50-007-006	915082
CATERPILLAR	933		SEALED	1.129	6.156	6.125	50-007-006	200281	A3540	50-007-006	915004
CATERPILLAR	939		SALT	1.318	7.535	6.735	50-007-005	25499	A3540	50-007-005	915149
CATERPILLAR	941	w/ 5/8 BOLT	SEALED	1.314	7.22	6.735	50-007-005	25499	A3540	50-007-005	915011
CATERPILLAR	941	w/ 9/16 BOLT	SEALED	1.314	7	6.735	50-007-005	25499	A3540	50-007-005	915002
CATERPILLAR	941		SALT	1.314	7.22	6.735	50-007-005	25499	A3540	50-007-005	915052
CATERPILLAR	943	HI RAIL	SALT	1.315	7.22	6.735	50-007-005	25499	A3540	50-007-005	915002
CATERPILLAR	943	HI RAIL	SALT	1.314	7.22	6.735	50-007-005	25499	A3540	50-007-005	915052
CATERPILLAR	951		SALT	1.442	8.12	6.906	50-007-004	25500	A3540	50-007-004	915052
CATERPILLAR	951		SEALED	1.442	8.125	6.735	50-007-004	25500	A3540	50-007-004	915009

WTC Machinery
100 Ton Field Press

CATERPILLAR	953	HI RAIL	SALT	1.442	8.12	6.906	50-007-004	25500	A3540	50-007-004	915052
CATERPILLAR	953		SALT	1.442	8.12	6.906	50-007-004	25500	A3540	50-007-004	915052
CATERPILLAR	953	LGP	SALT	1.442	8.12	6.906	50-007-004	25500	A3540	50-007-004	915052
CATERPILLAR	955	HD	SEALED	1.442	8.125	6.735	50-007-004	25500	A3540	50-007-004	915009
CATERPILLAR	955		SEALED	1.252	9.06	7.984	50-007-005	25498	A3540	50-007-005	915003
CATERPILLAR	955		SALT	1.753	9.06	7.98	50-007-002	25547	A3541	50-007-002	915003
CATERPILLAR	963		SALT	1.753	9.06	7.98	50-007-002	25547	A3541	50-007-002	915003
CATERPILLAR	963	HI RAIL	SALT	1.753	9.06	7.98	50-007-002	25547	A3541	50-007-002	915003
CATERPILLAR	973	HI RAIL	SALT	1.878	9.88	8.5	50-007-002	25551	A3541	50-007-002	915201
CATERPILLAR	973		SALT	1.877	9.88	8.5	50-007-002	25551	A3541	50-007-002	915006
CATERPILLAR	973	HI RAIL	SALT	1.877	9.88	8.5	50-007-002	25551	A3541	50-007-002	915006
CATERPILLAR	973	LGP	SALT	1.877	9.88	8.5	50-007-002	25551	A3541	50-007-002	915006
CATERPILLAR	973		SEALED	1.877	9.88	8.5	50-007-002	25551	A3541	50-007-002	915012
CATERPILLAR	977	OPT FORMER	SEALED	1.442	8.125	6.906	50-007-004	25500	A3540	50-007-004	915009
CATERPILLAR	977		SEALED	1.442	8.125	6.735	50-007-004	25500	A3540	50-007-004	915009
CATERPILLAR	977		SALT	1.877	9.88	8.5	50-007-002	25551	A3541	50-007-002	915006
CATERPILLAR	977		SEALED	1.877	9.88	8.5	50-007-002	25551	A3541	50-007-002	915012
CATERPILLAR	983		SEALED	2.003	11.438	9	50-007-001	25551	A3541	50-007-001	915001
CATERPILLAR	5080		SEALED	2.253	12.244	10.25	50-007-001	25553	A3541	N/A	915139

WTC Machinery
100 Ton Field Press

CATERPILLAR	5130		SALT	2.626	14.173	12.5	50-007-001	25553	A3541	N/A	
CATERPILLAR			SEALED	1.488	8.582	7.48	50-007-003	25500	A3540	50-007-003	915127
CATERPILLAR	E70B		SEALED	0.945	5.512	5.315	50-007-008	200281	A3539	50-007-008	915129
CATERPILLAR	14A		SEALED	1.752	11.438	7.985	50-007-002	25547	A3541	50-007-002	915013
CATERPILLAR	17A		SEALED	1.752	9.875	7.984	50-007-002	25547	A3541	50-007-002	915012
CATERPILLAR	215A		SEALED	1.442	8.12	7.48	50-007-004	25500	A3540	50-007-004	915052
CATERPILLAR	225B	EXC	SEALED	1.442	8.12	7.48	50-007-004	25500	A3540	50-007-004	915052
CATERPILLAR	225C	EXC	SEALED	1.442	8.12	7.48	50-007-004	25500	A3540	50-007-004	915052
CATERPILLAR	231D		SEALED	1.252	9.06	7.984	50-007-005	25498	A3540	50-007-005	915003
CATERPILLAR	235D		SEALED	2.003	11.438	9	50-007-001	25551	A3541	50-007-001	915001
CATERPILLAR	245S		SEALED	2.003	11.438	9	50-007-001	25551	A3541	50-007-001	915001
CATERPILLAR	307C		GREASE	0.94	5.15	6.06	50-007-008	200281	A3539	50-007-008	915169
CATERPILLAR	312C	EXC	GREASE	1.32	7	6.75	50-007-005	25499	A3540	50-007-005	915059
CATERPILLAR	313B	EXC	SEALED	1.321	7.01	6.75	50-007-005	25499	A3540	50-007-005	915059
CATERPILLAR	314B	EXC	SEALED	1.321	7.01	6.75	50-007-005	25499	A3540	50-007-005	915059
CATERPILLAR	315B	EXC	GREASE	1.442	8.15	7.48	50-007-004	25500	A3540	50-007-004	915236
CATERPILLAR	315C	EXC	GREASE	1.442	8.15	7.48	50-007-004	25500	A3540	50-007-004	915170
CATERPILLAR	318C	EXC	GREASE	1.442	8.15	7.48	50-007-004	25500	A3540	50-007-004	915170
CATERPILLAR	320B	EXC	SEALED	1.442	8.15	7.48	50-007-004	25500	A3540	50-007-004	915140

WTC Machinery
100 Ton Field Press

CATERPILLAR	320C	EXC	GREASE	1.442	8.15	7.48	50-007-004	25500	A3540	50-007-004	915170
CATERPILLAR	322B	EXC	GREASE	1.442	8.15	7.48	50-007-004	25500	A3540	50-007-004	915236
CATERPILLAR	322C	EXC	GREASE	1.442	8.15	7.48	50-007-004	25500	A3540	50-007-004	915170
CATERPILLAR	325BL	EXC	SEALED	1.654	9.055	8	50-007-003	25547	A3541	50-007-003	915141
CATERPILLAR	325C	EXC	GREASE	1.65	9.05	7.985	50-007-003	25547	A3541	50-007-003	915141
CATERPILLAR	330B	EXC	SEALED	1.811	9.665	8.5	50-007-002	25551	A3541	50-007-002	915015
CATERPILLAR	330B	EXC	GREASE	1.811	9.665	8.5	50-007-002	25551	A3541	50-007-002	915185
CATERPILLAR	330C	EXC	SEALED	1.811	9.665	8.5	50-007-002	25551	A3541	50-007-002	915015
CATERPILLAR	345B	EXC	SALT	1.877	9.882	8.5	50-007-002	25551	A3541	50-007-002	915200
CATERPILLAR	345B		SEALED	1.877	9.88	8.5	50-007-002	25551	A3541	50-007-002	915012
CATERPILLAR	345BL	EXC	SALT	1.877	9.882	8.5	50-007-002	25551	A3541	50-007-002	915200
CATERPILLAR	365BL	EXC	SEALED	2.253	12.244	10.25	50-007-001	25553	A3541	N/A	915139
CATERPILLAR	385B	EXC	SEALED	2.253	13.188	10.25	50-007-001	25553	A3541	N/A	915168
CATERPILLAR	561H	HD	SALT	1.418	8.445	6.735	50-007-004	25500	A3540	50-007-004	915145
CATERPILLAR	561H		SALT	1.318	7.535	6.735	50-007-005	25499	A3540	50-007-005	915149
CATERPILLAR	571A		SALT	1.877	9.88	8.5	50-007-002	25551	A3541	50-007-002	915006
CATERPILLAR	571A		SEALED	1.877	9.88	8.5	50-007-002	25551	A3541	50-007-002	915012
CATERPILLAR	583R	PIPELAYER	SALT	1.88	9.88	8.5	50-007-002	25551	A3541	50-007-002	915006
CATERPILLAR	933	CURRENT	SALT	1.126	6.161	6.125	50-007-006	200281	A3540	50-007-006	915082

WTC Machinery
100 Ton Field Press

CATERPILLAR	935B		SEALED	1.129	6.156	6.125	50-007-006	200281	A3540	50-007-006	915004
CATERPILLAR	935B		SALT	1.126	6.161	6.125	50-007-006	200281	A3540	50-007-006	915082
CATERPILLAR	935C		SALT	1.126	6.161	6.125	50-007-006	200281	A3540	50-007-006	915082
CATERPILLAR	951B		SEALED	1.442	8.125	6.906	50-007-004	25500	A3540	50-007-004	915009
CATERPILLAR	951B		SEALED	1.442	8.125	6.735	50-007-004	25500	A3540	50-007-004	915009
CATERPILLAR	951C		SEALED	1.442	8.125	6.906	50-007-004	25500	A3540	50-007-004	915009
CATERPILLAR	955K		SEALED	1.442	8.125	6.906	50-007-004	25500	A3540	50-007-004	915009
CATERPILLAR	977K		SEALED	1.752	9.875	7.984	50-007-002	25547	A3541	50-007-002	915012
CATERPILLAR	983		SALT	2.002	11.438	9	50-007-001	25551	A3541	50-007-001	915007
CATERPILLAR	AP1050		SEALED	1.129	6.156	6.125	50-007-006	200281	A3540	50-007-006	915004
CATERPILLAR	D10		PPR	2.252	11.974	10.25	50-007-001	25553	A3541	N/A	915240
CATERPILLAR	D10		SALT	2.253	12.25	10.25	50-007-001	25553	A3541	N/A	915063
CATERPILLAR	D10N		PPR	2.253	11.97	10.25	50-007-001	25553	A3541	N/A	A3326-004
CATERPILLAR	D10N		SALT	2.253	12.25	10.25	50-007-001	25553	A3541	N/A	915104
CATERPILLAR	D10R		PPR	2.253	11.97	10.25	50-007-001	25553	A3541	N/A	A3326-005
CATERPILLAR	D10R		SALT	2.253	12.25	10.25	50-007-001	25553	A3541	N/A	915104
CATERPILLAR	D10T		SALT	2.253	12.25	10.25	50-007-001	25553	A3541	N/A	915104
CATERPILLAR	D11		SALT	2.626	13.81	12.5	50-007-001	25553	A3541	N/A	915202
CATERPILLAR	D11N		PPR	2.252	11.97	12.5	50-007-001	25553	A3541	N/A	915203

WTC Machinery
100 Ton Field Press

CATERPILLAR	D11R		PPR	2.252	11.97	12.5	50-007-001	25553	A3541	N/A	915203
CATERPILLAR	D2		RECESS	1.127	6.156	6.125	50-007-006	200281	A3540	50-007-006	916040
CATERPILLAR	D2		SEALED	1.125	6.18	6.125	50-007-006	200281	A3540	50-007-006	915040
CATERPILLAR	D3		SEALED	1.129	6.156	6.125	50-007-006	200281	A3540	50-007-006	915004
CATERPILLAR	D3		SALT	1.126	6.161	6.125	50-007-006	200281	A3540	50-007-006	915082
CATERPILLAR	D3	EARLY	SALT	1.126	6.161	6.125	50-007-006	200281	A3540	50-007-006	915082
CATERPILLAR	D3		SALT	1.126	6.161	6.125	50-007-006	200281	A3540	50-007-006	915082
CATERPILLAR	D3	FORMER	SALT	1.126	6.161	6.125	50-007-006	200281	A3540	50-007-006	915082
CATERPILLAR	D3B		SEALED	1.129	6.156	6.125	50-007-006	200281	A3540	50-007-006	915004
CATERPILLAR	D3B		SALT	1.126	6.161	6.125	50-007-006	200281	A3540	50-007-006	915082
CATERPILLAR	D3C		SALT	1.126	6.161	6.125	50-007-006	200281	A3540	50-007-006	915082
CATERPILLAR	D3G		SEALED	1.129	6.156	6.125	50-007-006	200281	A3540	50-007-006	915004
CATERPILLAR	D3G		SALT	1.126	6.161	6.125	50-007-006	200281	A3540	50-007-006	915082
CATERPILLAR	D4		SEALED	1.314	7	6.735	50-007-005	25499	A3540	50-007-005	915002
CATERPILLAR	D4		RECESS	1.314	7	6.735	50-007-005	25499	A3540	50-007-005	915011
CATERPILLAR	D4	w/ 1/2 BOLT	SEALED	1.314	7	6.735	50-007-005	25499	A3540	50-007-005	915137
CATERPILLAR	D4	w/ 9/16 BOLT	SEALED	1.314	7	6.735	50-007-005	25499	A3540	50-007-005	915137
CATERPILLAR	D4	w/ 9/16 BOLT	SEALED	1.314	7	6.735	50-007-005	25499	A3540	50-007-005	915138
CATERPILLAR	D4		SALT	1.314	7.22	6.735	50-007-005	25499	A3540	50-007-005	915052

WTC Machinery
100 Ton Field Press

CATERPILLAR	D4B		SEALED	1.129	6.156	6.125	50-007-006	200281	A3540	50-007-006	915004
CATERPILLAR	D4B		SALT	1.126	6.161	6.125	50-007-006	200281	A3540	50-007-006	915082
CATERPILLAR	D4C		SEALED	1.129	6.156	6.125	50-007-006	200281	A3540	50-007-006	915004
CATERPILLAR	D4C		SALT	1.126	6.161	6.125	50-007-006	200281	A3540	50-007-006	915082
CATERPILLAR	D4C	w/ 1/2 BOLT	SEALED	1.314	7	6.735	50-007-005	25499	A3540	50-007-005	915137
CATERPILLAR	D4C	w/ 9/16 BOLT	SEALED	1.314	7	6.735	50-007-005	25499	A3540	50-007-005	915137
CATERPILLAR	D4C	w/ 9/16 BOLT	SEALED	1.314	7	6.735	50-007-005	25499	A3540	50-007-005	915138
CATERPILLAR	D4D		SEALED	1.314	7.22	6.735	50-007-005	25499	A3540	50-007-005	915011
CATERPILLAR	D4D		SEALED	1.314	7	6.735	50-007-005	25499	A3540	50-007-005	915002
CATERPILLAR	D4D		SALT	1.314	7.22	6.735	50-007-005	25499	A3540	50-007-005	915052
CATERPILLAR	D4D	w/ 1/2 BOLT	SEALED	1.314	7	6.735	50-007-005	25499	A3540	50-007-005	915137
CATERPILLAR	D4D	w/ 9/16 BOLT	SEALED	1.314	7	6.735	50-007-005	25499	A3540	50-007-005	915137
CATERPILLAR	D4D	w/ 9/16 BOLT	SEALED	1.314	7	6.735	50-007-005	25499	A3540	50-007-005	915138
CATERPILLAR	D4E		SALT	1.314	7.22	6.735	50-007-005	25499	A3540	50-007-005	915052
CATERPILLAR	D4G		SEALED	1.129	6.156	6.125	50-007-006	200281	A3540	50-007-006	915004
CATERPILLAR	D4G		SALT	1.126	6.161	6.125	50-007-006	200281	A3540	50-007-006	915082
CATERPILLAR	D4H		SALT	1.315	7.22	6.735	50-007-005	25499	A3540	50-007-005	915124
CATERPILLAR	D4H	HD	SALT	1.418	8.445	6.735	50-007-004	25500	A3540	50-007-004	915145
CATERPILLAR	D4H	LGP	PPR	1.315	7.287	6.735	50-007-005	25499	A3540	50-007-005	

WTC Machinery
100 Ton Field Press

CATERPILLAR	D4H		SALT	1.318	7.535	6.735	50-007-005	25499	A3540	50-007-005	915149
CATERPILLAR	D4H	TSK CUS SKD	SALT	1.318	7.535	6.735	50-007-005	25499	A3540	50-007-005	915149
CATERPILLAR	D5	PRO	SALT	1.442	8.12	6.906	50-007-004	25500	A3540	50-007-004	915052
CATERPILLAR	D5		SALT	1.442	8.12	6.906	50-007-004	25500	A3540	50-007-004	915018
CATERPILLAR	D5		SEALED	1.442	8.125	6.906	50-007-004	25500	A3540	50-007-004	915009
CATERPILLAR	D5		SALT	1.442	8.12	6.906	50-007-004	25500	A3540	50-007-004	915052
CATERPILLAR	D5B		SEALED	1.442	8.125	6.906	50-007-004	25500	A3540	50-007-004	915009
CATERPILLAR	D5B		SALT	1.442	8.12	6.906	50-007-004	25500	A3540	50-007-004	915052
CATERPILLAR	D5C		SALT	1.318	7.535	6.735	50-007-005	25499	A3540	50-007-005	915149
CATERPILLAR	D5G		SALT	1.318	7.535	6.735	50-007-005	25499	A3540	50-007-005	915149
CATERPILLAR	D5G	XL	SALT	1.318	7.535	6.735	50-007-005	25499	A3540	50-007-005	915149
CATERPILLAR	D5H		SALT	1.443	8.122	7.4803	50-007-004	25500	A3540	50-007-004	915052
CATERPILLAR	D5H	TSK CUS SKD	SALT	1.443	8.183	7.4803	50-007-004	25500	A3540	50-007-004	915052
CATERPILLAR	D5H	HD	SALT	1.495	9.392	7.48	50-007-003	25500	A3540	50-007-003	915145
CATERPILLAR	D5M		SALT	1.418	8.445	6.735	50-007-004	25500	A3540	50-007-004	915145
CATERPILLAR	D5N		SALT	1.418	8.445	6.735	50-007-004	25500	A3540	50-007-004	915145
CATERPILLAR	D6		RECESS	1.442	8.125	6.735	50-007-004	25500	A3540	50-007-004	915014
CATERPILLAR	D6		SEALED	1.442	8.125	6.735	50-007-004	25500	A3540	50-007-004	915009
CATERPILLAR	D6		SALT	1.753	9.06	7.9846	50-007-002	25547	A3541	50-007-002	915081

WTC Machinery
100 Ton Field Press

CATERPILLAR	D6B		SEALED	1.442	8.125	6.735	50-007-004	25500	A3540	50-007-004	915009
CATERPILLAR	D6C		SEALED	1.252	9.06	7.984	50-007-005	25498	A3540	50-007-005	915003
CATERPILLAR	D6C		SALT	1.753	9.06	7.98	50-007-002	25547	A3541	50-007-002	915003
CATERPILLAR	D6D		SEALED	1.252	9.06	7.984	50-007-005	25498	A3540	50-007-005	915003
CATERPILLAR	D6D		SALT	1.753	9.06	7.98	50-007-002	25547	A3541	50-007-002	915003
CATERPILLAR	D6E		SALT	1.753	9.06	7.98	50-007-002	25547	A3541	50-007-002	915003
CATERPILLAR	D6H	LGP	SALT	1.753	9.06	7.9846	50-007-002	25547	A3541	50-007-002	915081
CATERPILLAR	D6H		SALT	1.753	9.06	7.9846	50-007-002	25547	A3541	50-007-002	915081
CATERPILLAR	D6H	LGP	PPR	1.753	9.15	7.9846	50-007-002	25547	A3541	50-007-002	915143
CATERPILLAR	D6H	HD	SALT	1.753	10.315	8	50-007-002	25547	A3541	50-007-002	915143
CATERPILLAR	D6M		SALT	1.495	9.392	7.48	50-007-003	25500	A3540	50-007-003	915145
CATERPILLAR	D6N		SALT	1.495	9.392	7.48	50-007-003	25500	A3540	50-007-003	915145
CATERPILLAR	D6R		SALT	1.753	10.315	8	50-007-002	25547	A3541	50-007-002	915081
CATERPILLAR	D7		SALT	1.877	9.88	8.5	50-007-002	25551	A3541	50-007-002	915006
CATERPILLAR	D7		SEALED	1.752	9.875	7.984	50-007-002	25547	A3541	50-007-002	915012
CATERPILLAR	D7		RECESS	1.752	9.875	7.985	50-007-002	25547	A3541	50-007-002	915012
CATERPILLAR	D7C		SEALED	1.752	9.875	7.984	50-007-002	25547	A3541	50-007-002	915012
CATERPILLAR	D7D		SEALED	1.752	9.875	7.984	50-007-002	25547	A3541	50-007-002	915012
CATERPILLAR	D7D		RECESS	1.752	9.875	7.985	50-007-002	25547	A3541	50-007-002	915012

WTC Machinery
100 Ton Field Press

CATERPILLAR	D7E		SALT	1.877	9.88	8.5	50-007-002	25551	A3541	50-007-002	915006
CATERPILLAR	D7E		SEALED	1.877	9.88	8.5	50-007-002	25551	A3541	50-007-002	915012
CATERPILLAR	D7F		SALT	1.877	9.88	8.5	50-007-002	25551	A3541	50-007-002	915006
CATERPILLAR	D7F		SEALED	1.877	9.88	8.5	50-007-002	25551	A3541	50-007-002	915012
CATERPILLAR	D7G		SALT	1.877	9.88	8.5	50-007-002	25551	A3541	50-007-002	915006
CATERPILLAR	D7G	LGP	SALT	1.877	9.88	8.5	50-007-002	25551	A3541	50-007-002	915006
CATERPILLAR	D7G		SEALED	1.877	9.88	8.5	50-007-002	25551	A3541	50-007-002	915012
CATERPILLAR	D7H	LGP	PPR	1.878	9.925	8.5	50-007-002	25551	A3541	50-007-002	915007
CATERPILLAR	D7H		SALT	1.878	9.88	8.5	50-007-002	25551	A3541	50-007-002	915103
CATERPILLAR	D7H	HD	SALT	1.878	10.875	8.5	50-007-002	25551	A3541	50-007-002	915150
CATERPILLAR	D7R		SALT	1.878	10.875	8.5	50-007-002	25551	A3541	50-007-002	915150
CATERPILLAR	D8		RECESS	1.752	11.438	7.948	50-007-002	25547	A3541	50-007-002	915206
CATERPILLAR	D8		SEALED	1.752	11.438	7.985	50-007-002	25547	A3541	50-007-002	915013
CATERPILLAR	D8		SALT	2.002	11.438	9	50-007-001	25551	A3541	50-007-001	915007
CATERPILLAR	D8D		SEALED	1.752	11.438	7.985	50-007-002	25547	A3541	50-007-002	915013
CATERPILLAR	D8E		SEALED	1.752	11.438	7.985	50-007-002	25547	A3541	50-007-002	915013
CATERPILLAR	D8F		SEALED	1.752	11.438	7.985	50-007-002	25547	A3541	50-007-002	915013
CATERPILLAR	D8G		SEALED	1.752	11.438	7.985	50-007-002	25547	A3541	50-007-002	915013
CATERPILLAR	D8H		SALT	2.002	11.438	9	50-007-001	25551	A3541	50-007-001	915007

WTC Machinery
100 Ton Field Press

CATERPILLAR	D8H		SEALED	2.003	11.438	9	50-007-001	25551	A3541	50-007-001	915001
CATERPILLAR	D8K		SALT	2.002	11.438	9	50-007-001	25551	A3541	50-007-001	915007
CATERPILLAR	D8K		SEALED	2.003	11.438	9	50-007-001	25551	A3541	50-007-001	915001
CATERPILLAR	D8L		SALT	1.88	9.88	8.5	50-007-002	25551	A3541	50-007-002	915006
CATERPILLAR	D8N		SALT	1.88	9.88	8.5	50-007-002	25551	A3541	50-007-002	915006
CATERPILLAR	D8N		PPR	1.878	9.65	8.5	50-007-002	25551	A3541	50-007-002	915207
CATERPILLAR	D8R		SALT	1.88	9.88	8.5	50-007-002	25551	A3541	50-007-002	915006
CATERPILLAR	D8R		PPR	1.878	9.65	8.5	50-007-002	25551	A3541	50-007-002	A3326-001
CATERPILLAR	D8T		SALT	1.88	9.88	8.5	50-007-002	25551	A3541	50-007-002	915006
CATERPILLAR	D9		SEALED	2.002	12	9	50-007-001	25551	A3541	50-007-001	915208
CATERPILLAR	D9		SALT	2.252	12.25	10.25	50-007-001	25553	A3541	N/A	915008
CATERPILLAR	D9D		SEALED	2.252	12.25	10.25	50-007-001	25553	A3541	N/A	915005
CATERPILLAR	D9E		SEALED	2.252	12.25	10.25	50-007-001	25553	A3541	N/A	915005
CATERPILLAR	D9G		SALT	2.252	12.25	10.25	50-007-001	25553	A3541	N/A	915008
CATERPILLAR	D9G		SEALED	2.252	12.25	10.25	50-007-001	25553	A3541	N/A	915005
CATERPILLAR	D9H		SALT	2.252	12.25	10.25	50-007-001	25553	A3541	N/A	915008
CATERPILLAR	D9H		SEALED	2.252	12.25	10.25	50-007-001	25553	A3541	N/A	915005
CATERPILLAR	D9L		PPR	2	10.77	9	50-007-001	25551	A3541	50-007-001	A3326-002
CATERPILLAR	D9L		SALT	2	11.437	9	50-007-001	25551	A3541	50-007-001	915093

WTC Machinery
100 Ton Field Press

CATERPILLAR	D9N		SALT	2.003	10.98	9.45	50-007-001	25551	A3541	50-007-001	915092
CATERPILLAR	D9N		PPR	2	10.44	9.449	50-007-001	25551	A3541	50-007-001	A3326-003
CATERPILLAR	D9R		SALT	2.003	10.98	9.45	50-007-001	25551	A3541	50-007-001	915092
CATERPILLAR	D9R		PPR	2	10.44	9.449	50-007-001	25551	A3541	50-007-001	A3326-003
CATERPILLAR	E110B		SEALED	1.319	7.008	6.75	50-007-005	25499	A3540	50-007-005	915059
CATERPILLAR	E120B		SEALED	1.319	7.008	6.75	50-007-005	25499	A3540	50-007-005	915059
CATERPILLAR	E180		SEALED	1.439	8.126	6.906	50-007-004	25500	A3540	50-007-004	915128
CATERPILLAR	E200B		SEALED	1.445	8.15	7.5	50-007-004	25500	A3540	50-007-004	915133
CATERPILLAR	E240		SEALED	1.445	8.15	7.5	50-007-004	25500	A3540	50-007-004	915133
CATERPILLAR	E300B		SEALED	1.75	9.646	8	50-007-002	25547	A3541	50-007-002	915121
CATERPILLAR	E450		UNSEALED	1.873	10	8.5	50-007-002	25551	A3541	50-007-002	915038
CATERPILLAR	E70		SEALED	0.945	5.512	5.315	50-007-008	200281	A3539	50-007-008	915129
CATERPILLAR	EL180		SEALED	1.439	8.126	6.906	50-007-004	25500	A3540	50-007-004	915128
CATERPILLAR	EL200B		SEALED	1.445	8.15	7.5	50-007-004	25500	A3540	50-007-004	915133
CATERPILLAR	EL240		SEALED	1.445	8.15	7.5	50-007-004	25500	A3540	50-007-004	915133
CATERPILLAR	EL300A		SEALED	1.75	9.646	8	50-007-002	25547	A3541	50-007-002	915121
CATERPILLAR	EL300B		SEALED	1.75	9.646	8	50-007-002	25547	A3541	50-007-002	915121
CATERPILLAR	EL300B		SEALED	1.75	9.646	8	50-007-002	25547	A3541	50-007-002	915038
CATERPILLAR	FB227		SEALED	1.252	9.06	7.984	50-007-005	25498	A3540	50-007-005	915003

WTC Machinery
100 Ton Field Press

CATERPILLAR	MHI 180-8		SEALED	1.439	8.126	6.906	50-007-004	25500	A3540	50-007-004	915128
CATERPILLAR	MHI 180-8LC		SEALED	1.439	8.126	6.906	50-007-004	25500	A3540	50-007-004	915128
CATERPILLAR	MHI 300LC-8		SEALED	1.75	9.646	8	50-007-002	25547	A3541	50-007-002	915121
CATERPILLAR	PR450		SEALED	1.129	6.156	6.125	50-007-006	200281	A3540	50-007-006	915004
CATERPILLAR	R2-15-22		RECESS	1.127	6.156	6.125	50-007-006	200281	A3540	50-007-006	916040
CATERPILLAR	R4		RECESS	1.314	7	6.735	50-007-005	25499	A3540	50-007-005	915011
CATERPILLAR	SF350		SEALED	1.129	6.156	6.125	50-007-006	200281	A3540	50-007-006	915004
CATERPILLAR	TR225		SEALED	1.129	6.156	6.125	50-007-006	200281	A3540	50-007-006	915004
DRESSER	150		SEALED	1.375	6.69	6.49	50-007-004	25499	A3540	50-007-004	915048
DRESSER	175		SEALED	1.625	7.87	6.992	50-007-003	25547	A3541	50-007-003	915041
DRESSER	500		RECESSED	1.125	5.36	6	50-007-006	200281	A3540	50-007-006	915044
DRESSER	100B		SEALED	1.25	5.97	6	50-007-005	25498	A3540	50-007-005	915034
DRESSER	100C		SEALED	1.25	6.5	5.998	50-007-005	25498	A3540	50-007-005	915040
DRESSER	100E		SEALED	1.25	6.5	5.99	50-007-005	25498	A3540	50-007-005	915100
DRESSER	100G		SALT	1.312	6.69	6.49	50-007-005	25499	A3540	50-007-005	915133
DRESSER	125C		SEALED	1.375	6.69	6.49	50-007-004	25499	A3540	50-007-004	915048
DRESSER	125E		SEALED	1.375	6.69	6.49	50-007-004	25499	A3540	50-007-004	915048
DRESSER	125G		SALT	1.312	6.69	6.49	50-007-005	25499	A3540	50-007-005	915133
DRESSER	125G		SEALED	1.312	6.69	6.49	50-007-005	25499	A3540	50-007-005	915040

WTC Machinery
100 Ton Field Press

DRESSER	125G		DRY	1.312	6.69	6.49	50-007-005	25499	A3540	50-007-005	915213
DRESSER	175B		SEALED	1.625	7.87	6.992	50-007-003	25547	A3541	50-007-003	915041
DRESSER	175B		SEALED	1.75	8.81	7.5	50-007-002	25547	A3541	50-007-002	915036
DRESSER	175C		SEALED	1.75	8.81	7.5	50-007-002	25547	A3541	50-007-002	915036
DRESSER	250B		SEALED	1.75	9.31	7.5	50-007-002	25547	A3541	50-007-002	915036
DRESSER	250C		SEALED	1.75	9.31	7.5	50-007-002	25547	A3541	50-007-002	915036
DRESSER	500E		DRY	1.125	5.3	5.99	50-007-006	200281	A3540	50-007-006	915209
DRESSER	D32		SALT	1.312	6.69	6.49	50-007-005	25499	A3540	50-007-005	915133
DRESSER	D32E		SEALED	1.25	6.5	5.998	50-007-005	25498	A3540	50-007-005	915040
DRESSER	D32E		SALT	1.312	6.69	6.49	50-007-005	25499	A3540	50-007-005	915133
DRESSER	D32P		SEALED	1.25	6.5	5.998	50-007-005	25498	A3540	50-007-005	915040
DRESSER	D32-P1		SALT	1.312	6.69	6.49	50-007-005	25499	A3540	50-007-005	915133
DRESSER	D38E		SALT	1.312	6.69	6.49	50-007-005	25499	A3540	50-007-005	915133
DRESSER	D38P-1		SALT	1.312	6.69	6.49	50-007-005	25499	A3540	50-007-005	915133
DRESSER	D38P-1		SALT	1.312	6.69	6.49	50-007-005	25499	A3540	50-007-005	915133
DRESSER	D39		SALT	1.312	6.69	6.49	50-007-005	25499	A3540	50-007-005	915133
DRESSER	D39E		SALT	1.312	6.69	6.49	50-007-005	25499	A3540	50-007-005	915133
DRESSER	D87E-2		SALT	1.874	10.43	8.5	50-007-002	25551	A3541	50-007-002	915077
DRESSER	D87P		SALT	1.874	10.43	8.5	50-007-002	25551	A3541	50-007-002	915077

WTC Machinery
100 Ton Field Press

DRESSER	T340		FLUSH	1.01	4.75	6	50-007-006	200281	A3539	50-007-007	915028
DRESSER	T5		FLUSH	1.01	4.75	6	50-007-006	200281	A3539	50-007-007	915028
DRESSER	T6		SEALED	1.25	5.97	6	50-007-005	25498	A3540	50-007-005	915034
DRESSER	T7		SEALED	1.25	6.5	5.998	50-007-005	25498	A3540	50-007-005	915040
DRESSER	TD12		SALT	1.5	8.03	7.49	50-007-003	25500	A3540	50-007-003	915095
DRESSER	TD12		SEALED	1.75	8.03	7.49	50-007-002	25547	A3541	50-007-002	915095
DRESSER	TD12A		DRY	1.5	8.03	7.49	50-007-003	25500	A3540	50-007-003	915210
DRESSER	TD12B		DRY	1.5	8.03	7.49	50-007-003	25500	A3540	50-007-003	915210
DRESSER	TD12C		DRY	1.625	8.81	7.49	50-007-003	25547	A3541	50-007-003	915211
DRESSER	TD12C-XP		SEALED	1.629	8.82	7.49	50-007-003	25547	A3541	50-007-003	915083
DRESSER	TD14		SEALED	1.625	7.87	6.992	50-007-003	25547	A3541	50-007-003	915041
DRESSER	TD15		SEALED	1.625	7.87	6.992	50-007-003	25547	A3541	50-007-003	915041
DRESSER	TD15B		SEALED	1.625	7.87	6.992	50-007-003	25547	A3541	50-007-003	915041
DRESSER	TD15B		SEALED	1.75	8.81	7.5	50-007-002	25547	A3541	50-007-002	915036
DRESSER	TD15C		SEALED	1.75	8.81	7.5	50-007-002	25547	A3541	50-007-002	915036
DRESSER	TD15C		SALT	1.625	8.81	7.49	50-007-003	25547	A3541	50-007-003	915021
DRESSER	TD15C	LGP	SALT	1.625	8.81	7.49	50-007-003	25547	A3541	50-007-003	915021
DRESSER	TD15C	SPLIT	SEALED	1.625	8.81	7.49	50-007-003	25547	A3541	50-007-003	915021
DRESSER	TD15C	SPLIT	DRY	1.625	8.81	7.49	50-007-003	25547	A3541	50-007-003	915211

WTC Machinery
100 Ton Field Press

DRESSER	TD15E		SEALED	1.75	8.81	7.98	50-007-002	25547	A3541	50-007-002	915108
DRESSER	TD15E		SALT	1.75	8.81	7.98	50-007-002	25547	A3541	50-007-002	915109
DRESSER	TD15E	LGP	SALT	1.75	8.81	7.98	50-007-002	25547	A3541	50-007-002	915109
DRESSER	TD20B		SEALED	1.75	9.31	7.5	50-007-002	25547	A3541	50-007-002	915036
DRESSER	TD20C		SEALED	1.75	9.31	7.5	50-007-002	25547	A3541	50-007-002	915036
DRESSER	TD20C		SEALED	1.875	9.31	8.5	50-007-002	25551	A3541	50-007-002	915035
DRESSER	TD20E		SALT	1.874	10.43	8.5	50-007-002	25551	A3541	50-007-002	915077
DRESSER	TD20E		DRY	1.874	10.43	8.5	50-007-002	25551	A3541	50-007-002	915212
DRESSER	TD20E		SEALED	1.875	10.44	8.5	50-007-002	25551	A3541	50-007-002	915038
DRESSER	TD20E	SPLIT	SEALED	1.875	10.43	8.5	50-007-002	25551	A3541	50-007-002	915077
DRESSER	TD20G		SALT	1.874	10.43	8.5	50-007-002	25551	A3541	50-007-002	915077
DRESSER	TD20G	LGP	SALT	1.874	10.43	8.5	50-007-002	25551	A3541	50-007-002	915077
DRESSER	TD20G		DRY	1.874	10.43	8.5	50-007-002	25551	A3541	50-007-002	915212
DRESSER	TD24		SEALED	1.875	11	8.5	50-007-002	25551	A3541	50-007-002	915037
DRESSER	TD25B		SEALED	1.875	11	8.5	50-007-002	25551	A3541	50-007-002	915037
DRESSER	TD25C		SALT	2.125	11	9.87	50-007-001	25501	A3541	50-007-001	915102
DRESSER	TD25C		SALT	2.125	11	9.86	50-007-001	25501	A3541	50-007-001	915102
DRESSER	TD25C		SEALED	2.125	11	9.87	50-007-001	25501	A3541	50-007-001	915102
DRESSER	TD25E		SALT	2.125	11	9.87	50-007-001	25501	A3541	50-007-001	915102

WTC Machinery
100 Ton Field Press

DRESSER	TD25E		SALT	2.125	11	9.86	50-007-001	25501	A3541	50-007-001	915102
DRESSER	TD25E		SEALED	2.125	11	9.87	50-007-001	25501	A3541	50-007-001	915102
DRESSER	TD25E	SPLIT	SEALED	2.125	11	9.87	50-007-001	25501	A3541	50-007-001	915102
DRESSER	TD25G		SALT	2.125	11	9.87	50-007-001	25501	A3541	50-007-001	915102
DRESSER	TD25G		DRY	2.125	11	9.86	50-007-001	25501	A3541	50-007-001	915102
DRESSER	TD30		SALT	2.125	11	9.86	50-007-001	25501	A3541	50-007-001	915102
DRESSER	TD30		SEALED	2.125	11	9.87	50-007-001	25501	A3541	50-007-001	915102
DRESSER	TD4		FLUSH	1.01	4.75	6	50-007-006	200281	A3539	50-007-007	915028
DRESSER	TD40	SPLIT	SEALED	2.456	12.6	11.02	50-007-001	25553	A3541	N/A	915101
DRESSER	TD40	SPLIT	SALT	2.456	12.6	11.02	50-007-001	25553	A3541	N/A	915101
DRESSER	TD5		FLUSH	1.01	4.75	6	50-007-006	200281	A3539	50-007-007	915028
DRESSER	TD6		SEALED	1.25	5.97	6	50-007-005	25498	A3540	50-007-005	915034
DRESSER	TD7		SEALED	1.25	6.5	5.998	50-007-005	25498	A3540	50-007-005	915040
DRESSER	TD7C		SEALED	1.25	6.5	5.998	50-007-005	25498	A3540	50-007-005	915040
DRESSER	TD7E		SEALED	1.25	6.5	5.99	50-007-005	25498	A3540	50-007-005	915100
DRESSER	TD7G		SALT	1.312	6.69	6.49	50-007-005	25499	A3540	50-007-005	915133
DRESSER	TD7H		DRY	1.312	6.69	6.49	50-007-005	25499	A3540	50-007-005	915213
DRESSER	TD8C		SEALED	1.375	6.69	6.49	50-007-004	25499	A3540	50-007-004	915048
DRESSER	TD8E		SEALED	1.375	6.69	6.49	50-007-004	25499	A3540	50-007-004	915048

WTC Machinery
100 Ton Field Press

DRESSER	TD8G		SALT	1.312	6.69	6.49	50-007-005	25499	A3540	50-007-005	915133
DRESSER	TD8G		SEALED	1.312	6.69	6.49	50-007-005	25499	A3540	50-007-005	915040
DRESSER	TD-8G		DRY	1.312	6.69	6.49	50-007-005	25499	A3540	50-007-005	915213
DRESSER	TD9B		SEALED	1.375	6.69	6.49	50-007-004	25499	A3540	50-007-004	915048
DRESSER	TD9H		SALT	1.312	6.69	6.49	50-007-005	25499	A3540	50-007-005	915133
FIAT	31		SALT	2.374	12.953	11.281	50-007-001	25553	A3541	N/A	915221
FIAT	31		DRY	2.374	12.953	11.281	50-007-001	25553	A3541	N/A	915142
FIAT	652		UNSEALED	1.25	6.24	6	50-007-005	25498	A3540	50-007-005	915004
FIAT	653		UNSEALED	1.25	6.24	6	50-007-005	25498	A3540	50-007-005	915004
FIAT	655		UNSEALED	1.25	6.24	6	50-007-005	25498	A3540	50-007-005	915004
FIAT	12G		SEALED	1.876	10.27	7.85	50-007-002	25551	A3541	50-007-002	915020
FIAT	12G		UNSEALED	1.874	10.27	7.858	50-007-002	25551	A3541	50-007-002	915020
FIAT	12GB		SEALED	1.878	10.27	7.858	50-007-002	25551	A3541	50-007-002	915030
FIAT	14B		UNSEALED	1.578	8.661	7.48	50-007-003	25547	A3540	50-007-003	915022
FIAT	41B		SALT	2.622	14	11.281	50-007-001	25553	A3541	N/A	915218
FIAT	41B		DRY	2.622	14	11.281	50-007-001	25553	A3541	N/A	915218
FIAT	AD10		UNSEALED	1.459	7.874	6.929	50-007-004	25500	A3540	50-007-004	915022
FIAT	AD10B		UNSEALED	1.459	7.874	6.929	50-007-004	25500	A3540	50-007-004	915022
FIAT	AD12		UNSEALED	1.578	8.661	7.48	50-007-003	25547	A3540	50-007-003	915022

WTC Machinery
100 Ton Field Press

FIAT	AD12		SALT	1.577	8.66	6	50-007-003	25547	A3540	50-007-003	915022
FIAT	AD14		UNSEALED	1.578	8.661	7.48	50-007-003	25547	A3540	50-007-003	915022
FIAT	AD14		SALT	1.577	8.66	6	50-007-003	25547	A3540	50-007-003	915022
FIAT	AD18		UNSEALED	1.87	9.84	8.503	50-007-002	25551	A3541	50-007-002	915019
FIAT	AD20		UNSEALED	1.87	9.84	8.503	50-007-002	25551	A3541	50-007-002	915019
FIAT	AD4		UNSEALED	0.984	5.28	5.512	50-007-006	200281	A3539	50-007-007	915028
FIAT	AD5		UNSEALED	1.181	6.1	6.299	50-007-006	25498	A3540	50-007-006	915027
FIAT	AD6		UNSEALED	1.377	7.01	6.692	50-007-004	25499	A3540	50-007-004	915025
FIAT	AD7		UNSEALED	1.377	7.01	6.692	50-007-004	25499	A3540	50-007-004	915025
FIAT	AD7C		UNSEALED	1.377	7.01	6.692	50-007-004	25499	A3540	50-007-004	915025
FIAT	AD8		UNSEALED	1.38	7.126	6.693	50-007-004	25499	A3540	50-007-004	915025
FIAT	AD9		UNSEALED	1.377	7.01	6.692	50-007-004	25499	A3540	50-007-004	915025
FIAT	B1		UNSEALED	0.984	5.28	5.512	50-007-006	200281	A3539	50-007-007	915028
FIAT	BD10		UNSEALED	1.459	7.874	6.929	50-007-004	25500	A3540	50-007-004	915022
FIAT	BD10B		UNSEALED	1.459	7.874	6.929	50-007-004	25500	A3540	50-007-004	915022
FIAT	BD12		UNSEALED	1.578	8.661	7.48	50-007-003	25547	A3540	50-007-003	915022
FIAT	BD12		SALT	1.577	8.66	6	50-007-003	25547	A3540	50-007-003	915022
FIAT	BD14		UNSEALED	1.578	8.661	7.48	50-007-003	25547	A3540	50-007-003	915022
FIAT	BD14		SALT	1.577	8.66	6	50-007-003	25547	A3540	50-007-003	915022

WTC Machinery
100 Ton Field Press

FIAT	BD18		UNSEALED	1.87	9.84	8.503	50-007-002	25551	A3541	50-007-002	915019
FIAT	BD20		UNSEALED	1.87	9.84	8.503	50-007-002	25551	A3541	50-007-002	915019
FIAT	BD7		UNSEALED	1.377	7.01	6.692	50-007-004	25499	A3540	50-007-004	915025
FIAT	BD7C		UNSEALED	1.377	7.01	6.692	50-007-004	25499	A3540	50-007-004	915025
FIAT	BD8		UNSEALED	1.38	7.126	6.693	50-007-004	25499	A3540	50-007-004	915025
FIAT	BD9		UNSEALED	1.377	7.01	6.692	50-007-004	25499	A3540	50-007-004	915025
FIAT	F318		SEALED	1.377	7.165	6.692	50-007-004	25499	A3540	50-007-004	915154
FIAT	FA200		SALT	1.577	8.66	6	50-007-003	25547	A3540	50-007-003	915022
FIAT	FD14		SALT	1.577	8.66	6	50-007-003	25547	A3540	50-007-003	915022
FIAT	FD20		UNSEALED	1.873	9.843	8.504	50-007-002	25551	A3541	50-007-002	915019
FIAT	FD20		SALT	1.88	9.9	8.503	50-007-002	25551	A3541	50-007-002	915006
FIAT	FD30		UNSEALED	2.036	11.66	9.042	50-007-001	25501	A3541	50-007-001	915016
FIAT	FD30		SALT	2.036	11.65	9.035	50-007-001	25501	A3541	50-007-001	915105
FIAT	FD31		SEALED	2.373	12.95	11.25	50-007-001	25553	A3541	N/A	915029
FIAT	FD31		UNSEALED	2.375	12.95	11.25	50-007-001	25553	A3541	N/A	915073
FIAT	FD31		SALT	2.373	12.95	11.281	50-007-001	25553	A3541	N/A	915094
FIAT	FD40		UNSEALED	2.375	12.95	11.25	50-007-001	25553	A3541	N/A	915073
FIAT	FD40		SALT	2.373	12.95	11.281	50-007-001	25553	A3541	N/A	915094
FIAT	FD40		SALT	2.374	12.953	11.281	50-007-001	25553	A3541	N/A	915221

WTC Machinery
100 Ton Field Press

FIAT	FD40		DRY	2.374	12.953	11.281	50-007-001	25553	A3541	N/A	915142
FIAT	FD40B		SALT	2.374	12.953	11.281	50-007-001	25553	A3541	N/A	915221
FIAT	FD40B		DRY	2.374	12.953	11.281	50-007-001	25553	A3541	N/A	915142
FIAT	FD5		UNSEALED	1.143	6.457	6.299	50-007-006	25498	A3540	50-007-006	915120
FIAT	FD5		SALT	1.26	6.42	6.299	50-007-005	25498	A3540	50-007-005	915130
FIAT	FD50		SALT	2.622	14	11.281	50-007-001	25553	A3541	N/A	915218
FIAT	FD50		DRY	2.622	14	11.281	50-007-001	25553	A3541	N/A	915218
FIAT	FD7		UNSEALED	1.143	6.457	6.299	50-007-006	25498	A3540	50-007-006	915120
FIAT	FD7		SALT	1.26	6.42	6.299	50-007-005	25498	A3540	50-007-005	915130
FIAT	FD9		UNSEALED	1.382	7.17	6.692	50-007-004	25499	A3540	50-007-004	915014
FIAT	FD9		SALT	1.382	7.17	6.692	50-007-004	25499	A3540	50-007-004	915014
FIAT	FE16		SEALED	1.377	7.165	6.692	50-007-004	25499	A3540	50-007-004	915154
FIAT	FE20		SEALED	1.377	7.165	6.692	50-007-004	25499	A3540	50-007-004	915154
FIAT	FE20LC		SEALED	1.377	7.165	6.692	50-007-004	25499	A3540	50-007-004	915154
FIAT	FE8LC		SEALED	1.377	7.165	6.692	50-007-004	25499	A3540	50-007-004	915154
FIAT	FH120		SEALED	1.377	7.165	6.692	50-007-004	25499	A3540	50-007-004	915154
FIAT	FH150		SEALED	1.377	7.165	6.692	50-007-004	25499	A3540	50-007-004	915154
FIAT	FH150LC		SEALED	1.377	7.165	6.692	50-007-004	25499	A3540	50-007-004	915154
FIAT	FH200		SEALED	1.458	8.031	6.929	50-007-004	25500	A3540	50-007-004	915118

WTC Machinery
100 Ton Field Press

FIAT	FH200LC		SEALED	1.458	8.031	6.929	50-007-004	25500	A3540	50-007-004	915118
FIAT	FL10		UNSEALED	1.459	7.874	6.929	50-007-004	25500	A3540	50-007-004	915022
FIAT	FL10B		UNSEALED	1.459	7.874	6.929	50-007-004	25500	A3540	50-007-004	915022
FIAT	FL12		UNSEALED	1.578	8.661	7.48	50-007-003	25547	A3540	50-007-003	915022
FIAT	FL14		UNSEALED	1.578	8.661	7.48	50-007-003	25547	A3540	50-007-003	915022
FIAT	FL14		SALT	1.577	8.66	6	50-007-003	25547	A3540	50-007-003	915022
FIAT	FL14B		UNSEALED	1.578	8.661	7.48	50-007-003	25547	A3540	50-007-003	915022
FIAT	FL14C		UNSEALED	1.578	8.661	7.48	50-007-003	25547	A3540	50-007-003	915022
FIAT	FL14D		SALT	1.577	8.66	6	50-007-003	25547	A3540	50-007-003	915022
FIAT	FL14E		SALT	1.577	8.66	6	50-007-003	25547	A3540	50-007-003	915022
FIAT	FL20	S/N 7607 & DN	UNSEALED	1.873	9.843	8.504	50-007-002	25551	A3541	50-007-002	915019
FIAT	FL20	7608 & UP	SALT	1.88	9.9	8.503	50-007-002	25551	A3541	50-007-002	915006
FIAT	FL4AC		UNSEALED	0.984	5.28	5.512	50-007-006	200281	A3539	50-007-007	915028
FIAT	FL4AD		UNSEALED	0.984	5.28	5.512	50-007-006	200281	A3539	50-007-007	915028
FIAT	FL4L		UNSEALED	0.984	5.28	5.512	50-007-006	200281	A3539	50-007-007	915028
FIAT	FL5		UNSEALED	1.143	6.457	6.299	50-007-006	25498	A3540	50-007-006	915120
FIAT	FL5		SALT	1.26	6.42	6.299	50-007-005	25498	A3540	50-007-005	915130
FIAT	FL5B		SALT	1.26	6.42	6.299	50-007-005	25498	A3540	50-007-005	915130
FIAT	FL6		UNSEALED	1.181	6.1	6.299	50-007-006	25498	A3540	50-007-006	915027

WTC Machinery
100 Ton Field Press

FIAT	FL7		UNSEALED	1.143	6.457	6.299	50-007-006	25498	A3540	50-007-006	915120
FIAT	FL7		SALT	1.26	6.42	6.299	50-007-005	25498	A3540	50-007-005	915130
FIAT	FL7		UNSEALED	1.377	7.01	6.692	50-007-004	25499	A3540	50-007-004	915025
FIAT	FL7B		SALT	1.26	6.42	6.299	50-007-005	25498	A3540	50-007-005	915130
FIAT	FL8		UNSEALED	1.377	7.01	6.692	50-007-004	25499	A3540	50-007-004	915025
FIAT	FL8C		UNSEALED	1.377	7.01	6.692	50-007-004	25499	A3540	50-007-004	915025
FIAT	FL9		UNSEALED	1.38	7.126	6.693	50-007-004	25499	A3540	50-007-004	915025
FIAT	FP120	S/N 41-3000	SALT	2.374	12.953	11.281	50-007-001	25553	A3541	N/A	915221
FIAT	FP120	S/N 41-3000	DRY	2.374	12.953	11.281	50-007-001	25553	A3541	N/A	915142
FIAT	GH11E	S/N 10000 & DN	UNSEALED	1.565	8.14	7	50-007-003	25547	A3540	50-007-003	915214
FIAT	H3			1.253	5.84	6	50-007-005	25498	A3540	50-007-005	915219
FIAT	H4		UNSEALED	1.25	6.24	6	50-007-005	25498	A3540	50-007-005	915004
FIAT	H4			1.253	5.84	6	50-007-005	25498	A3540	50-007-005	915219
FIAT	HD10			1.753	8.37	7.85	50-007-002	25547	A3541	50-007-002	915220
FIAT	HD11	S/N 7538- 10000	SEALED	1.562	8.14	7	50-007-003	25547	A3540	50-007-003	915031
FIAT	HD11	SN 5901 & UP	SEALED	1.62	8.4	7.006	50-007-003	25547	A3540	50-007-003	915024
FIAT	HD11	S/N 10001 & UP	UNSEALED	1.62	8.4	7.006	50-007-003	25547	A3540	50-007-003	915024
FIAT	HD11	S/N 1000 & DN	UNSEALED	1.565	8.14	7.006	50-007-003	25547	A3540	50-007-003	915023
FIAT	HD11B		SEALED	1.62	8.4	7.006	50-007-003	25547	A3540	50-007-003	915024

WTC Machinery
100 Ton Field Press

FIAT	HD11B	S/N 10001-19484	UNSEALED	1.62	8.4	7.006	50-007-003	25547	A3540	50-007-003	915024
FIAT	HD11B	S/N 19485 & UP	UNSEALED	1.62	8.6	7.006	50-007-003	25547	A3540	50-007-003	915215
FIAT	HD11E	S/N 10000 & DN	SEALED	1.565	8.14	7.006	50-007-003	25547	A3540	50-007-003	915023
FIAT	HD11G	S/N 8940 & DN	SEALED	1.565	8.14	7.006	50-007-003	25547	A3540	50-007-003	915023
FIAT	HD11G	S/N 8940 & DN	UNSEALED	1.565	8.14	7	50-007-003	25547	A3540	50-007-003	915214
FIAT	HD11G	S/N 8940 & UP	UNSEALED	1.565	8.14	7.006	50-007-003	25547	A3540	50-007-003	915023
FIAT	HD14			1.878	9.67	7.85	50-007-002	25551	A3541	50-007-002	915216
FIAT	HD14			1.875	9.67	7.85	50-007-002	25551	A3541	50-007-002	915020
FIAT	HD15		UNSEALED	1.753	9.33	7.858	50-007-002	25547	A3541	50-007-002	915021
FIAT	HD16	S/N 5901 & UP	SEALED	1.876	10.27	7.85	50-007-002	25551	A3541	50-007-002	915020
FIAT	HD16	S/N 5900 & DN	UNSEALED	1.753	9.33	7.858	50-007-002	25547	A3541	50-007-002	915021
FIAT	HD16	S/N 5901 & UP	UNSEALED	1.874	10.27	7.858	50-007-002	25551	A3541	50-007-002	915020
FIAT	HD16B		SEALED	1.878	10.27	7.858	50-007-002	25551	A3541	50-007-002	915030
FIAT	HD19		SEALED	1.878	11.66	9.008	50-007-002	25551	A3541	50-007-002	915017
FIAT	HD19		UNSEALED	1.876	11.66	9	50-007-002	25551	A3541	50-007-002	915217
FIAT	HD19		SEALED	1.876	11.66	9	50-007-002	25551	A3541	50-007-002	915017
FIAT	HD20		SEALED	1.878	11.66	9.008	50-007-002	25551	A3541	50-007-002	915017
FIAT	HD20		UNSEALED	1.876	11.66	9	50-007-002	25551	A3541	50-007-002	915217
FIAT	HD20		SEALED	1.876	11.66	9	50-007-002	25551	A3541	50-007-002	915017

WTC Machinery
100 Ton Field Press

FIAT	HD21	S/N 13871-14942	SEALED	1.878	11.66	9.008	50-007-002	25551	A3541	50-007-002	915017
FIAT	HD21		UNSEALED	1.878	11.66	9.008	50-007-002	25551	A3541	50-007-002	915017
FIAT	HD21	S/N14943 & UP	SEALED	1.878	11.66	9.008	50-007-002	25551	A3541	50-007-002	915017
FIAT	HD21	S/N 14942 & DN	UNSEALED	1.878	11.66	9.008	50-007-002	25551	A3541	50-007-002	915221
FIAT	HD21B		SEALED	1.876	11.66	9	50-007-002	25551	A3541	50-007-002	915016
FIAT	HD21B		UNSEALED	1.876	11.66	9	50-007-002	25551	A3541	50-007-002	915018
FIAT	HD21C		UNSEALED	2.036	11.66	9.042	50-007-001	25501	A3541	1/na	915016
FIAT	HD21P	S/N 14942 & DN	UNSEALED	1.876	11.66	9	50-007-002	25551	A3541	50-007-002	915217
FIAT	HD21P	S/N 14942 & DN	SEALED	1.876	11.66	9	50-007-002	25551	A3541	50-007-002	915017
FIAT	HD21P	S/N 14943 & UP	UNSEALED	1.878	11.66	9.008	50-007-002	25551	A3541	50-007-002	915017
FIAT	HD3			1.253	5.84	6	50-007-005	25498	A3540	50-007-005	915219
FIAT	HD31		UNSEALED	2.375	12.95	11.25	50-007-001	25553	A3541	N/A	915073
FIAT	HD31		SALT	2.373	12.95	11.281	50-007-001	25553	A3541	N/A	915094
FIAT	HD4	S/N 3001 & UP	UNSEALED	1.25	6.24	6	50-007-005	25498	A3540	50-007-005	915004
FIAT	HD4			1.253	5.84	6	50-007-005	25498	A3540	50-007-005	915219
FIAT	HD41		SEALED	2.373	12.95	11.25	50-007-001	25553	A3541	N/A	915029
FIAT	HD41		UNSEALED	2.375	12.95	11.25	50-007-001	25553	A3541	N/A	915073
FIAT	HD41		SALT	2.373	12.95	11.281	50-007-001	25553	A3541	N/A	915094
FIAT	HD41B		UNSEALED	2.623	14	11.28	50-007-001	25553	A3541	N/A	915033

WTC Machinery
100 Ton Field Press

FIAT	HD41B		SALT	2.622	14	11.28	50-007-001	25553	A3541	N/A	915218
FIAT	HD5		SEALED	1.375	6.91	6.495	50-007-004	25499	A3540	50-007-004	915014
FIAT	HD5		UNSEALED	1.375	6.91	6.495	50-007-004	25499	A3540	50-007-004	915014
FIAT	HD5			1.753	8.37	7.85	50-007-002	25547	A3541	50-007-002	915220
FIAT	HD50		UNSEALED	2.623	14	11.28	50-007-001	25553	A3541	N/A	915033
FIAT	HD50		SALT	2.622	14	11.28	50-007-001	25553	A3541	N/A	915218
FIAT	HD50			1.753	8.37	7.85	50-007-002	25547	A3541	50-007-002	915220
FIAT	HD6		SEALED	1.375	6.91	6.495	50-007-004	25499	A3540	50-007-004	915014
FIAT	HD6		UNSEALED	1.375	6.91	6.495	50-007-004	25499	A3540	50-007-004	915014
FIAT	HD7	S/N 1102 & DN	UNSEALED	1.738	7.51	6.5	50-007-002	25547	A3541	50-007-002	915026
FIAT	HD7	S/N 1103 & UP	UNSEALED	1.565	8.14	6.5	50-007-003	25547	A3540	50-007-003	915023
FIAT	HD7G		SEALED	1.565	8.14	7.006	50-007-003	25547	A3540	50-007-003	915023
FIAT	HD7G		UNSEALED	1.565	8.14	7	50-007-003	25547	A3540	50-007-003	915214
FIAT	HD7G		UNSEALED	1.565	8.14	7.006	50-007-003	25547	A3540	50-007-003	915023
FIAT	HD7G-B		SEALED	1.562	8.14	7	50-007-003	25547	A3540	50-007-003	915031
FIAT	HD9		SEALED	1.565	8.14	7.006	50-007-003	25547	A3540	50-007-003	915023
FIAT	HD9		UNSEALED	1.565	8.14	7	50-007-003	25547	A3540	50-007-003	915214
FIAT	HD9		UNSEALED	1.565	8.14	7.006	50-007-003	25547	A3540	50-007-003	915023
FIAT	K		UNSEALED	1.738	7.51	6.5	50-007-002	25547	A3541	50-007-002	915026

WTC Machinery
100 Ton Field Press

FIAT	KO		UNSEALED	1.738	7.51	6.5	50-007-002	25547	A3541	50-007-002	915026
FIAT	PH130		SEALED	1.377	7.165	6.692	50-007-004	25499	A3540	50-007-004	915154
FIAT	S11		SEALED	1.377	7.165	6.692	50-007-004	25499	A3540	50-007-004	915154
FIAT	S9		SEALED	1.377	7.165	6.692	50-007-004	25499	A3540	50-007-004	915154
FIAT	SL11	33/281 & UP	SEALED	1.377	7.165	6.692	50-007-004	25499	A3540	50-007-004	915154
FIAT	SL9	30/241 & UP	SEALED	1.377	7.165	6.692	50-007-004	25499	A3540	50-007-004	915154
HITACHI	EX100		UNSEALED	1.315	7.283	6.736	50-007-005	25499	A3540	50-007-005	915223
HITACHI	EX1100		SEALED	2.29	12.578	10.25	50-007-001	25553	A3541	N/A	915171
HITACHI	EX120		UNSEALED	1.315	7.283	6.736	50-007-005	25499	A3540	50-007-005	915223
HITACHI	EX1200-5		SEALED	2.29	12.578	10.25	50-007-001	25553	A3541	N/A	915171
HITACHI	EX150		SEALED	1.378	7.598	6.75	50-007-004	25499	A3540	50-007-004	915002
HITACHI	EX1800		SEALED	2.756	14.45	12.5	50-007-001	25553	A3541	N/A	915107
HITACHI	EX200		SEALED	1.442	8.346	7.484	50-007-004	25500	A3540	50-007-004	915134
HITACHI	EX220		SEALED	1.496	8.346	7.48	50-007-003	25500	A3540	50-007-003	915042
HITACHI	EX300		SEALED	1.75	9.65	8	50-007-002	25547	A3541	50-007-002	915121
HITACHI	EX400		SEALED	1.875	10	8.5	50-007-002	25551	A3541	50-007-002	915012
HITACHI	EX550		SEALED	1.909	11.57	9	50-007-002	25551	A3541	50-007-002	915087
HITACHI	EX700		SEALED	2.185	12.61	10.25	50-007-001	25501	A3541	50-007-001	915125
HITACHI	EX800		SEALED	2.185	12.61	10.25	50-007-001	25501	A3541	50-007-001	915125

WTC Machinery
100 Ton Field Press

HITACHI	EX90		UNSEALED	1.315	7.283	6.736	50-007-005	25499	A3540	50-007-005	915223
HITACHI	UH083		SALT	1.44	8.11	6.909	50-007-004	25500	A3540	50-007-004	915042
HITACHI	UH801		SALT	2.756	14.37	12.5	50-007-001	25553	A3541	N/A	915090
HITACHI	ZX350		SEALED	1.75	9.65	8	50-007-002	25547	A3541	50-007-002	915121
JOHN DEERE	50		SEALED	0.867	4.84	5.315	50-007-008	200281	A3539	50-007-008	915027
JOHN DEERE	70		SEALED	1.19	6.102	6.063	50-007-006	25498	A3540	50-007-006	915025
JOHN DEERE	80		SEALED	0.95	5.157	6.062	50-007-008	200281	A3539	50-007-008	915074
JOHN DEERE	110		SEALED	1.319	7.008	6.75	50-007-005	25499	A3540	50-007-005	915002
JOHN DEERE	120		SEALED	1.319	7.008	6.75	50-007-005	25499	A3540	50-007-005	915002
JOHN DEERE	135		SEALED	1.319	7.008	6.75	50-007-005	25499	A3540	50-007-005	915002
JOHN DEERE	350		FLUSH	1.192	5.47	5.7485	50-007-006	25498	A3540	50-007-006	915065
JOHN DEERE	370		SEALED	1.873	10	8.5	50-007-002	25551	A3541	50-007-002	915087
JOHN DEERE	440		FLUSH	1.004	5.46875	5.7485	50-007-006	200281	A3539	50-007-007	915064
JOHN DEERE	450		FLUSH	1.3765	6.08	6.29	50-007-004	25499	A3540	50-007-004	915056
JOHN DEERE	450		RECESSED	1.376	6.08	6.29	50-007-004	25499	A3540	50-007-004	915056
JOHN DEERE	490		RECESSED	1.32	6.97	6.75	50-007-005	25499	A3540	50-007-005	915074
JOHN DEERE	550		SEALED	1.376	6.2	6.29	50-007-004	25499	A3540	50-007-004	915074
JOHN DEERE	555		SEALED	1.376	6.2	6.29	50-007-004	25499	A3540	50-007-004	915074
JOHN DEERE	590	S/N 001787 & UP		1.366	7.598	6.75	50-007-004	25499	A3540	50-007-004	915228

WTC Machinery
100 Ton Field Press

JOHN DEERE	655		SEALED	1.44	8.11	6.909	50-007-004	25500	A3540	50-007-004	915042
JOHN DEERE	655		SALT	1.44	8.11	6.9909	50-007-004	25500	A3540	50-007-004	915042
JOHN DEERE	700		SALT	1.44	8.11	6.9909	50-007-004	25500	A3540	50-007-004	915042
JOHN DEERE	750		SEALED	1.44	8.11	6.909	50-007-004	25500	A3540	50-007-004	915042
JOHN DEERE	750		SALT	1.44	8.11	6.9909	50-007-004	25500	A3540	50-007-004	915042
JOHN DEERE	755		SEALED	1.44	8.11	6.909	50-007-004	25500	A3540	50-007-004	915042
JOHN DEERE	755		SALT	1.44	8.11	6.9909	50-007-004	25500	A3540	50-007-004	915042
JOHN DEERE	790		SEALED	1.496	8.58	7.48	50-007-003	25500	A3540	50-007-003	915022
JOHN DEERE	792		SEALED	1.75	9.646	8	50-007-002	25547	A3541	50-007-002	915121
JOHN DEERE	850		SEALED	1.75	9.06	8	50-007-002	25547	A3541	50-007-002	915013
JOHN DEERE	855		SEALED	1.878	9.902	8.5	50-007-002	25551	A3541	50-007-002	915083
JOHN DEERE	855		SALT	1.881	9.882	8.5	50-007-002	25551	A3541	50-007-002	915006
JOHN DEERE	890		SEALED	1.878	9.902	8.5	50-007-002	25551	A3541	50-007-002	915083
JOHN DEERE	890		RECESSED	1.88	9.9	8.5	50-007-002	25551	A3541	50-007-002	915227
JOHN DEERE	990		SEALED	1.878	9.902	8.5	50-007-002	25551	A3541	50-007-002	915083
JOHN DEERE	1280	EXC		1.439	8.11	6.9	50-007-004	25500	A3540	50-007-004	915229
JOHN DEERE	2010	S/N 42001 & UP	FLUSH	1.192	5.47	5.7485	50-007-006	25498	A3540	50-007-006	915065
JOHN DEERE	2010	S/N 42000 & DN	FLUSH	1.004	5.46875	5.7485	50-007-006	200281	A3539	50-007-007	915064
JOHN DEERE	1050C			2	10.31	8.5	50-007-001	25551	A3541	50-007-001	915172

WTC Machinery
100 Ton Field Press

JOHN DEERE	1050J			2	10.31	8.5	50-007-001	25551	A3541	50-007-001	915172
JOHN DEERE	1150D		SALT	1.44	8.11	6.678	50-007-004	25500	A3540	50-007-004	915215
JOHN DEERE	1155D		SALT	1.44	8.11	6.678	50-007-004	25500	A3540	50-007-004	915215
JOHN DEERE	120 EXC		SEALED	1.3	7.24	6.96	50-007-005	25499	A3540	50-007-005	915059
JOHN DEERE	120C		SEALED	1.319	7.008	6.75	50-007-005	25499	A3540	50-007-005	915002
JOHN DEERE	160LC		SEALED	1.493	8.366	7.48	50-007-003	25500	A3540	50-007-003	915042
JOHN DEERE	190E		SEALED	1.19	6.102	6.063	50-007-006	25498	A3540	50-007-006	915025
JOHN DEERE	190E			1.19	6.102	6.063	50-007-006	25498	A3540	50-007-006	915230
JOHN DEERE	200LC		SEALED	1.493	8.366	7.48	50-007-003	25500	A3540	50-007-003	915042
JOHN DEERE	230		SEALED	1.493	8.366	7.48	50-007-003	25500	A3540	50-007-003	915042
JOHN DEERE	230CLC		SEALED	1.496	8.583	7.48	50-007-003	25500	A3540	50-007-003	915023
JOHN DEERE	230LC		SEALED	1.496	8.583	7.48	50-007-003	25500	A3540	50-007-003	915023
JOHN DEERE	230LC		SEALED	1.493	8.366	7.48	50-007-003	25500	A3540	50-007-003	915042
JOHN DEERE	240D		SEALED	1.496	8.583	7.48	50-007-003	25500	A3540	50-007-003	915023
JOHN DEERE	270CLC		SEALED	1.76	9.52	8.5	50-007-002	25547	A3541	50-007-002	915162
JOHN DEERE	270LC		SEALED	1.75	9.646	8	50-007-002	25547	A3541	50-007-002	915121
JOHN DEERE	290D		SEALED	1.181	6.456	6.125	50-007-006	25498	A3540	50-007-006	915136
JOHN DEERE	291		SEALED	1.181	6.456	6.125	50-007-006	25498	A3540	50-007-006	915136
JOHN DEERE	330CLC		SEALED	1.76	9.52	8.5	50-007-002	25547	A3541	50-007-002	915162

WTC Machinery
100 Ton Field Press

JOHN DEERE	330LC	EXC	SEALED	1.76	9.52	8.5	50-007-002	25547	A3541	50-007-002	915162
JOHN DEERE	350B		FLUSH	1.192	5.47	5.7485	50-007-006	25498	A3540	50-007-006	915065
JOHN DEERE	350C		FLUSH	1.192	5.47	5.7485	50-007-006	25498	A3540	50-007-006	915065
JOHN DEERE	350D		SEALED	1.192	5.38	5.749	50-007-006	25498	A3540	50-007-006	915027
JOHN DEERE	400G		SEALED	1.192	5.38	5.749	50-007-006	25498	A3540	50-007-006	915027
JOHN DEERE	420C		FLUSH	1.004	5.46875	5.7485	50-007-006	200281	A3539	50-007-007	915064
JOHN DEERE	450B		RECESSED	1.376	6.08	6.29	50-007-004	25499	A3540	50-007-004	915056
JOHN DEERE	450C	S/N 216337 & DN	RECESSED	1.376	6.08	6.29	50-007-004	25499	A3540	50-007-004	915056
JOHN DEERE	450C		SALT	1.256	6.378	6.29	50-007-005	25498	A3540	50-007-005	915014
JOHN DEERE	450C	S/N 216338 & UP	SEALED	1.376	6.2	6.29	50-007-004	25499	A3540	50-007-004	915074
JOHN DEERE	450CLC		SEALED	1.873	10	8.5	50-007-002	25551	A3541	50-007-002	915087
JOHN DEERE	450D		SEALED	1.259	6.358	6.29	50-007-005	25498	A3540	50-007-005	915046
JOHN DEERE	450D		SALT	1.256	6.378	6.29	50-007-005	25498	A3540	50-007-005	915014
JOHN DEERE	450E		SEALED	1.259	6.358	6.29	50-007-005	25498	A3540	50-007-005	915046
JOHN DEERE	450G		SEALED	1.259	6.358	6.29	50-007-005	25498	A3540	50-007-005	915046
JOHN DEERE	450G		SALT	1.256	6.378	6.29	50-007-005	25498	A3540	50-007-005	915014
JOHN DEERE	450H		SEALED	1.259	6.358	6.29	50-007-005	25498	A3540	50-007-005	915046
JOHN DEERE	450H		SALT	1.256	6.378	6.29	50-007-005	25498	A3540	50-007-005	915014
JOHN DEERE	450J		SEALED	1.259	6.358	6.29	50-007-005	25498	A3540	50-007-005	915046

WTC Machinery
100 Ton Field Press

JOHN DEERE	450J		SALT	1.256	6.378	6.29	50-007-005	25498	A3540	50-007-005	915014
JOHN DEERE	450LC		SEALED	1.873	10	8.5	50-007-002	25551	A3541	50-007-002	915087
JOHN DEERE	455D		SEALED	1.259	6.358	6.29	50-007-005	25498	A3540	50-007-005	915046
JOHN DEERE	455G		SEALED	1.259	6.358	6.29	50-007-005	25498	A3540	50-007-005	915046
JOHN DEERE	455G		SALT	1.256	6.378	6.29	50-007-005	25498	A3540	50-007-005	915014
JOHN DEERE	490D		SEALED	1.319	7.008	6.75	50-007-005	25499	A3540	50-007-005	915002
JOHN DEERE	490E		SEALED	1.33	6.7	6.73	50-007-005	25499	A3540	50-007-005	915166
JOHN DEERE	550A		SEALED	1.259	6.358	6.29	50-007-005	25498	A3540	50-007-005	915046
JOHN DEERE	550A		SALT	1.256	6.378	6.29	50-007-005	25498	A3540	50-007-005	915014
JOHN DEERE	550B		SEALED	1.259	6.358	6.29	50-007-005	25498	A3540	50-007-005	915046
JOHN DEERE	550B		SALT	1.256	6.378	6.29	50-007-005	25498	A3540	50-007-005	915014
JOHN DEERE	550G		SALT	1.256	6.378	6.29	50-007-005	25498	A3540	50-007-005	915014
JOHN DEERE	550G		SEALED	1.259	6.358	6.29	50-007-005	25498	A3540	50-007-005	915046
JOHN DEERE	550H		SEALED	1.259	6.358	6.29	50-007-005	25498	A3540	50-007-005	915046
JOHN DEERE	550H		SALT	1.256	6.378	6.29	50-007-005	25498	A3540	50-007-005	915014
JOHN DEERE	550J		SALT	1.256	6.378	6.29	50-007-005	25498	A3540	50-007-005	915014
JOHN DEERE	555G		SALT	1.31	7.24	6.734	50-007-005	25499	A3540	50-007-005	915089
JOHN DEERE	555G		SEALED	1.318	7.224	6.29	50-007-005	25499	A3540	50-007-005	915089
JOHN DEERE	590D		SEALED	1.378	7.598	6.75	50-007-004	25499	A3540	50-007-004	915002

WTC Machinery
100 Ton Field Press

JOHN DEERE	590D	S/N 1787 & UP	SEALED	1.366	7.598	6.75	50-007-004	25499	A3540	50-007-004	915142
JOHN DEERE	650G		SALT	1.31	7.24	6.734	50-007-005	25499	A3540	50-007-005	915089
JOHN DEERE	650G		SEALED	1.318	7.224	6.29	50-007-005	25499	A3540	50-007-005	915089
JOHN DEERE	650H		SALT	1.31	7.24	6.734	50-007-005	25499	A3540	50-007-005	915089
JOHN DEERE	650H		SEALED	1.318	7.224	6.29	50-007-005	25499	A3540	50-007-005	915089
JOHN DEERE	650J		SALT	1.31	7.24	6.734	50-007-005	25499	A3540	50-007-005	915089
JOHN DEERE	650J		SEALED	1.318	7.224	6.29	50-007-005	25499	A3540	50-007-005	915089
JOHN DEERE	655B		SALT	1.44	8.11	6.9909	50-007-004	25500	A3540	50-007-004	915042
JOHN DEERE	690A		RECESSED	1.32	6.97	6.75	50-007-005	25499	A3540	50-007-005	915074
JOHN DEERE	690B		RECESSED	1.32	6.97	6.75	50-007-005	25499	A3540	50-007-005	915074
JOHN DEERE	690C		RECESSED	1.32	6.97	6.75	50-007-005	25499	A3540	50-007-005	915074
JOHN DEERE	690D		RECESSED	1.32	6.97	6.75	50-007-005	25499	A3540	50-007-005	915074
JOHN DEERE	690E		SEALED	1.437	8.15	7.48	50-007-004	25500	A3540	50-007-004	915079
JOHN DEERE	690ELC		SEALED	1.437	8.15	7.48	50-007-004	25500	A3540	50-007-004	915079
JOHN DEERE	693B		RECESSED	1.32	6.97	6.75	50-007-005	25499	A3540	50-007-005	915074
JOHN DEERE	693D		SEALED	1.44	8.11	6.909	50-007-004	25500	A3540	50-007-004	915042
JOHN DEERE	700J		SALT	1.44	8.11	6.9909	50-007-004	25500	A3540	50-007-004	915042
JOHN DEERE	70D		SEALED	1.19	6.102	6.063	50-007-006	25498	A3540	50-007-006	915025
JOHN DEERE	750B		SEALED	1.44	8.11	6.909	50-007-004	25500	A3540	50-007-004	915042

WTC Machinery
100 Ton Field Press

JOHN DEERE	750B		SALT	1.44	8.11	6.9909	50-007-004	25500	A3540	50-007-004	915042
JOHN DEERE	750C		SALT	1.437	8.125	7.48	50-007-004	25500	A3540	50-007-004	915052
JOHN DEERE	750J		SALT	1.496	9.39	7.48	50-007-003	25500	A3540	50-007-003	915080
JOHN DEERE	755A		SEALED	1.753	9.13	7.984	50-007-002	25547	A3541	50-007-002	915099
JOHN DEERE	755B		SEALED	1.44	8.11	6.909	50-007-004	25500	A3540	50-007-004	915042
JOHN DEERE	755C		SALT	1.753	9.06	7.984	50-007-002	25547	A3541	50-007-002	915106
JOHN DEERE	755C		SEALED	1.75	9.06	8	50-007-002	25547	A3541	50-007-002	915013
JOHN DEERE	790D		SEALED	1.496	8.583	7.48	50-007-003	25500	A3540	50-007-003	915023
JOHN DEERE	790E		SEALED	1.493	8.366	7.48	50-007-003	25500	A3540	50-007-003	915042
JOHN DEERE	790ELC		SEALED	1.493	8.366	7.48	50-007-003	25500	A3540	50-007-003	915042
JOHN DEERE	792D		SEALED	1.75	9.646	8	50-007-002	25547	A3541	50-007-002	915121
JOHN DEERE	80C		SEALED	0.95	5.157	6.062	50-007-008	200281	A3539	50-007-008	915074
JOHN DEERE	850B		SALT	1.753	9.06	7.984	50-007-002	25547	A3541	50-007-002	915106
JOHN DEERE	850B		SEALED	1.753	9.13	7.984	50-007-002	25547	A3541	50-007-002	915099
JOHN DEERE	850C		SALT	1.753	9.06	7.984	50-007-002	25547	A3541	50-007-002	915106
JOHN DEERE	850C		SEALED	1.75	9.06	8	50-007-002	25547	A3541	50-007-002	915013
JOHN DEERE	850J		SALT	1.75	10.315	8	50-007-002	25547	A3541	50-007-002	915175
JOHN DEERE	890A		SEALED	1.878	9.902	8.5	50-007-002	25551	A3541	50-007-002	915083
JOHN DEERE	892D		SEALED	1.75	9.646	8	50-007-002	25547	A3541	50-007-002	915121

WTC Machinery
100 Ton Field Press

JOHN DEERE	892E		SEALED	1.75	9.646	8	50-007-002	25547	A3541	50-007-002	915121
JOHN DEERE	950J		SALT	1.87	10.86	8.5	50-007-002	25551	A3541	50-007-002	915189
JOHN DEERE	992D		SEALED	1.873	10	8.5	50-007-002	25551	A3541	50-007-002	915087
JOHN DEERE	992E		SEALED	1.873	10	8.5	50-007-002	25551	A3541	50-007-002	915087
JOHN DEERE	EX120		SEALED	1.319	7.008	6.75	50-007-005	25499	A3540	50-007-005	915002
JOHN DEERE	EX120-2		SEALED	1.33	6.7	6.73	50-007-005	25499	A3540	50-007-005	915166
JOHN DEERE	EX150		SEALED	1.378	7.598	6.75	50-007-004	25499	A3540	50-007-004	915002
JOHN DEERE	JD700		SEALED	1.44	8.11	6.909	50-007-004	25500	A3540	50-007-004	915042
JOHN DEERE	JD700HL GP		SEALED	1.44	8.11	6.909	50-007-004	25500	A3540	50-007-004	915042
JOHN DEERE	JD700HL GP		SALT	1.44	8.11	6.9909	50-007-004	25500	A3540	50-007-004	915042
KOBELCO	K909A		UNSEALED	1.496	8.58	7.48	50-007-003	25500	A3540	50-007-003	915023
KOMATSU	D455A-1	S/N 1090- 1333	SALT	2.76	14.37	12.5	50-007-001	25553	A3541	N/A	915090
KOMATSU	EX1800- PC1800	133 mm	SALT	2.76	13.78	12.51	50-007-001	25553	A3541	N/A	915107
KOMATSU	D120-15		SEALED	1.988	11.3	9	50-007-001	25551	A3541	50-007-001	915055
KOMATSU	D120-18		SEALED	1.988	11.3	9	50-007-001	25551	A3541	50-007-001	915055
KOMATSU	D120-8		SEALED	1.988	11.3	9	50-007-001	25551	A3541	50-007-001	915055
KOMATSU	D125-18		RECESSED	1.988	11.3	9	50-007-001	25551	A3541	50-007-001	915206
KOMATSU	D135A-1			1.909	11.575	9	50-007-002	25551	A3541	50-007-002	
KOMATSU	D150-1	S/N 6842 & DN	SEALED	1.988	11.3	9	50-007-001	25551	A3541	50-007-001	915055

WTC Machinery
100 Ton Field Press

KOMATSU	D150-1	S/N 6843 & UP	SEALED	1.929	11.54	9	50-007-002	25551	A3541	50-007-002	915086
KOMATSU	D150-1		SALT	1.909	11.57	9	50-007-002	25551	A3541	50-007-002	915055
KOMATSU	D150-1	S/N 6842 & DN	UNSEALED	1.988	11.299	9	50-007-001	25551	A3541	50-007-001	915055
KOMATSU	D150-1	S/N 6843 & UP	UNSEALED	1.929	11.535	9	50-007-002	25551	A3541	50-007-002	915086
KOMATSU	D155		SEALED	1.988	11.3	9	50-007-001	25551	A3541	50-007-001	915055
KOMATSU	D155		SALT	1.909	11.57	9	50-007-002	25551	A3541	50-007-002	915055
KOMATSU	D155-1	S/N 6842 & DN	SEALED	1.988	11.3	9	50-007-001	25551	A3541	50-007-001	915055
KOMATSU	D155-1	S/N 6843 & UP	SEALED	1.929	11.54	9	50-007-002	25551	A3541	50-007-002	915086
KOMATSU	D155-1		SALT	1.909	11.57	9	50-007-002	25551	A3541	50-007-002	915055
KOMATSU	D155-1	S/N 6843 & UP	UNSEALED	1.929	11.535	9	50-007-002	25551	A3541	50-007-002	915086
KOMATSU	D155-1	S/N 6842 & DN	UNSEALED	1.988	11.299	9	50-007-001	25551	A3541	50-007-001	915055
KOMATSU	D155-1	S/N 10263-19064	SEALED	1.9069	11.5747	9	50-007-002	25551	A3541	50-007-002	915087
KOMATSU	D155-1	S/N 19065 & UP	SALT	1.9094	11.574	9	50-007-002	25551	A3541	50-007-002	915087
KOMATSU	D155A		SALT	1.909	11.57	9	50-007-002	25551	A3541	50-007-002	915055
KOMATSU	D155A-1	S/N 2540-10262	SEALED	1.909	11.3	9	50-007-002	25551	A3541	50-007-002	915055
KOMATSU	D155A-2		SALT	1.9094	11.574	9	50-007-002	25551	A3541	50-007-002	915087
KOMATSU	D155A-2		SEALED	1.909	11.48	9	50-007-002	25551	A3541	50-007-002	915087
KOMATSU	D155A-5		SEALED	1.909	11.48	9	50-007-002	25551	A3541	50-007-002	915167
KOMATSU	D155AX-3		SEALED	1.909	11.48	9	50-007-002	25551	A3541	50-007-002	915167

WTC Machinery
100 Ton Field Press

KOMATSU	D155AX-5		SEALED	1.909	11.48	9	50-007-002	25551	A3541	50-007-002	915167
KOMATSU	D20		SEALED	0.945	5.63	5.31	50-007-008	200281	A3539	50-007-008	915124
KOMATSU	D20		SALT	0.945	5.55	5.31	50-007-008	200281	A3539	50-007-008	915123
KOMATSU	D21		SEALED	0.945	5.63	5.31	50-007-008	200281	A3539	50-007-008	915124
KOMATSU	D21		SALT	0.945	5.55	5.31	50-007-008	200281	A3539	50-007-008	915123
KOMATSU	D250		RECESSED	2.165	12.323	10.25	50-007-001	25501	A3541	50-007-001	915054
KOMATSU	D275A-2		SALT	2.24	12.61	10.25	50-007-001	25553	A3541	N/A	915063
KOMATSU	D30-15		SEALED	1.102	6.594	6.063	50-007-006	200281	A3539	50-007-007	915057
KOMATSU	D30A		SEALED	1.102	6.594	6.063	50-007-006	200281	A3539	50-007-007	915057
KOMATSU	D30S-1		SEALED	1.094	6.59	6.06	50-007-006	200281	A3539	50-007-007	915058
KOMATSU	D30S-15	S/N 5016 & UP	SEALED	1.102	6.594	6.063	50-007-006	200281	A3539	50-007-007	915057
KOMATSU	D31		UNSEALED	1.18	6.69	6.06	50-007-006	25498	A3540	50-007-006	915069
KOMATSU	D31-15		SEALED	1.102	6.594	6.063	50-007-006	200281	A3539	50-007-007	915057
KOMATSU	D31-16		SEALED	1.102	6.693	6.063	50-007-006	200281	A3539	50-007-007	915058
KOMATSU	D31-16		SALT	1.102	6.6929	6.0629	50-007-006	200281	A3539	50-007-007	915058
KOMATSU	D31E		SALT	1.102	6.6929	6.0629	50-007-006	200281	A3539	50-007-007	915058
KOMATSU	D31E-12		SEALED	1.102	6.594	6.063	50-007-006	200281	A3539	50-007-007	915057
KOMATSU	D31P		UNSEALED	1.18	6.69	6.06	50-007-006	25498	A3540	50-007-006	915069
KOMATSU	D31P		SALT	1.102	6.6929	6.0629	50-007-006	200281	A3539	50-007-007	915058

WTC Machinery
100 Ton Field Press

KOMATSU	D31P-20		SALT	1.102	6.6929	6.0629	50-007-006	200281	A3539	50-007-007	915058
KOMATSU	D31PL		SALT	1.102	6.6929	6.0629	50-007-006	200281	A3539	50-007-007	915058
KOMATSU	D31PLL	S/N 29001 & UP	SALT	1.102	6.6929	6.0629	50-007-006	200281	A3539	50-007-007	915058
KOMATSU	D31PX		SALT	1.102	6.6929	6.0629	50-007-006	200281	A3539	50-007-007	915058
KOMATSU	D31S		SALT	1.102	6.6929	6.0629	50-007-006	200281	A3539	50-007-007	915058
KOMATSU	D355		FLUSH	2.244	12.579	10.25	50-007-001	25553	A3541	N/A	915053
KOMATSU	D355		SALT	2.185	12.736	10.25	50-007-001	25501	A3541	50-007-001	915091
KOMATSU	D355A-1	S/N 1010- 1631	SEALED	2.244	12.578	10.25	50-007-001	25553	A3541	N/A	915088
KOMATSU	D355A-3	S/N 1632- 4233	SEALED	2.185	12.736	10.25	50-007-001	25501	A3541	50-007-001	915091
KOMATSU	D355A-3	S/N 4234 & UP	SALT	2.185	12.736	10.25	50-007-001	25501	A3541	50-007-001	915091
KOMATSU	D37		SALT	1.102	6.6929	6.0629	50-007-006	200281	A3539	50-007-007	915058
KOMATSU	D375		SALT	2.24	12.61	10.25	50-007-001	25553	A3541	N/A	915063
KOMATSU	D375A-1		SALT	2.24	12.61	10.25	50-007-001	25553	A3541	N/A	915063
KOMATSU	D375A-2		SALT	2.36	12.77	11.04	50-007-001	25553	A3541	N/A	915131
KOMATSU	D375A-3		SALT	2.36	12.77	11.04	50-007-001	25553	A3541	N/A	915131
KOMATSU	D375A-5		SALT	2.362	12.77	11.04	50-007-001	25553	A3541	N/A	915165
KOMATSU	D37P		SALT	1.102	6.6929	6.0629	50-007-006	200281	A3539	50-007-007	915058
KOMATSU	D39E		SALT	1.307	7.244	6.75	50-007-005	25499	A3540	50-007-005	915052
KOMATSU	D39EX		SALT	1.307	7.244	6.75	50-007-005	25499	A3540	50-007-005	915052

WTC Machinery
100 Ton Field Press

KOMATSU	D39P		SALT	1.307	7.244	6.75	50-007-005	25499	A3540	50-007-005	915052
KOMATSU	D39PX		SALT	1.307	7.244	6.75	50-007-005	25499	A3540	50-007-005	915052
KOMATSU	D40		RECESSED	1.488	8.5826	6.89	50-007-003	25500	A3540	50-007-003	915059
KOMATSU	D40		SALT	1.377	7.13	6.89	50-007-004	25499	A3540	50-007-004	915060
KOMATSU	D40		SEALED	1.382	7.17	6.89	50-007-004	25499	A3540	50-007-004	915060
KOMATSU	D40P-1	BERCO	SEALED	1.496	8.661	6.906	50-007-003	25500	A3540	50-007-003	915059
KOMATSU	D41	NEW	SALT	1.382	7.17	6.89	50-007-004	25499	A3540	50-007-004	915122
KOMATSU	D41		UNSEALED	1.499	8.66	6.89	50-007-003	25500	A3540	50-007-003	915122
KOMATSU	D41		SEALED	1.382	7.17	6.89	50-007-004	25499	A3540	50-007-004	915060
KOMATSU	D41-6		SALT	1.307	7.244	6.75	50-007-005	25499	A3540	50-007-005	915052
KOMATSU	D41A	BERCO	SEALED	1.496	8.661	6.906	50-007-003	25500	A3540	50-007-003	915059
KOMATSU	D41E	S/N 50201 & UP	SALT	1.307	7.224	6.75	50-007-005	25499	A3540	50-007-005	915067
KOMATSU	D41E		SALT	1.307	7.244	6.75	50-007-005	25499	A3540	50-007-005	915052
KOMATSU	D41P		SALT	1.307	7.244	6.75	50-007-005	25499	A3540	50-007-005	915052
KOMATSU	D41P	BERCO	SEALED	1.496	8.661	6.906	50-007-003	25500	A3540	50-007-003	915059
KOMATSU	D41P-6	S/N 50201 & UP	SALT	1.307	7.224	6.75	50-007-005	25499	A3540	50-007-005	915067
KOMATSU	D41PX-12		SALT	1.432	7.845	6.875	50-007-004	25500	A3540	50-007-004	915163
KOMATSU	D41Q-3	BERCO	SEALED	1.496	8.661	6.906	50-007-003	25500	A3540	50-007-003	915059
KOMATSU	D41S	BERCO	SEALED	1.496	8.661	6.906	50-007-003	25500	A3540	50-007-003	915059

WTC Machinery
100 Ton Field Press

KOMATSU	D45		RECESSED	1.488	8.5826	6.89	50-007-003	25500	A3540	50-007-003	915059
KOMATSU	D455		SALT	2.76	14.37	12.5	50-007-001	25553	A3541	N/A	915090
KOMATSU	D455A-1	S/N 1334 & UP	SALT	2.7559	14.37	12.5	50-007-001	25553	A3541	N/A	915090
KOMATSU	D455A-1	S/N 1004- 1089	SALT	2.76	14.37	12.5	50-007-001	25553	A3541	N/A	915090
KOMATSU	D45A		SEALED	1.382	7.17	6.89	50-007-004	25499	A3540	50-007-004	915059
KOMATSU	D45A	S/N 12178 & UP BERCO	SEALED	1.496	8.661	6.906	50-007-003	25500	A3540	50-007-003	915059
KOMATSU	D45B	S/N 12178 & UP BERCO	SEALED	1.496	8.661	6.906	50-007-003	25500	A3540	50-007-003	915059
KOMATSU	D45P-1	S/N 1501 & UP	SEALED	1.382	7.17	6.89	50-007-004	25499	A3540	50-007-004	915059
KOMATSU	D475A-1		SALT	2.76	14.4	12.51	50-007-001	25553	A3541	N/A	915107
KOMATSU	D475A-2		SALT	2.76	14.4	12.51	50-007-001	25553	A3541	N/A	915107
KOMATSU	D475A-3		SALT	2.76	13.78	12.51	50-007-001	25553	A3541	N/A	915239
KOMATSU	D475A-5		SALT	2.76	13.78	12.51	50-007-001	25553	A3541	N/A	915238
KOMATSU	D50		RECESSED	1.488	8.5826	6.89	50-007-003	25500	A3540	50-007-003	915059
KOMATSU	D50		SALT	1.377	7.13	6.89	50-007-004	25499	A3540	50-007-004	915060
KOMATSU	D50		SEALED	1.382	7.17	6.89	50-007-004	25499	A3540	50-007-004	915060
KOMATSU	D50-11		RECESSED	1.488	8.5826	6.89	50-007-003	25500	A3540	50-007-003	915059
KOMATSU	D50-15		RECESSED	1.488	8.5826	6.89	50-007-003	25500	A3540	50-007-003	915059
KOMATSU	D50-15		SEALED	1.382	7.17	6.89	50-007-004	25499	A3540	50-007-004	915059
KOMATSU	D50A	BERCO	SEALED	1.496	8.661	6.906	50-007-003	25500	A3540	50-007-003	915059

WTC Machinery
100 Ton Field Press

KOMATSU	D50B	S/N 10901 & UP BERCO	SEALED	1.496	8.661	6.906	50-007-003	25500	A3540	50-007-003	915059
KOMATSU	D50P	S/N 10901 & UP BERCO	SEALED	1.496	8.661	6.906	50-007-003	25500	A3540	50-007-003	915059
KOMATSU	D50S	S/N 10901 & UP BERCO	SEALED	1.496	8.661	6.906	50-007-003	25500	A3540	50-007-003	915059
KOMATSU	D50S-11		RECESSED	1.488	8.5826	6.89	50-007-003	25500	A3540	50-007-003	915059
KOMATSU	D53	NEW	SALT	1.382	7.17	6.89	50-007-004	25499	A3540	50-007-004	915122
KOMATSU	D53		UNSEALED	1.499	8.66	6.89	50-007-003	25500	A3540	50-007-003	915122
KOMATSU	D53		SALT	1.377	7.13	6.89	50-007-004	25499	A3540	50-007-004	915060
KOMATSU	D53-15		SEALED	1.382	7.17	6.89	50-007-004	25499	A3540	50-007-004	915059
KOMATSU	D53-16		SEALED	1.382	7.17	6.89	50-007-004	25499	A3540	50-007-004	915060
KOMATSU	D53A	BERCO	SEALED	1.496	8.661	6.906	50-007-003	25500	A3540	50-007-003	915059
KOMATSU	D53A-15	S/N 60001 & UP	SEALED	1.382	7.17	6.89	50-007-004	25499	A3540	50-007-004	915059
KOMATSU	D55		SEALED	1.496	8.661	7.48	50-007-003	25500	A3540	50-007-003	915060
KOMATSU	D55-S		RECESSED	1.488	8.583	7.48	50-007-003	25500	A3540	50-007-003	915056
KOMATSU	D57-1		SEALED	1.496	8.661	7.48	50-007-003	25500	A3540	50-007-003	915060
KOMATSU	D575-1		DRY TRACK	1.5	8.66	7.48	50-007-003	25500	A3540	50-007-003	915233
KOMATSU	D575A-2		SALT	2.913	17.32	12.508	50-007-001	25553	A3541	N/A	
KOMATSU	D575A-3		SALT	2.913	17.32	12.508	50-007-001	25553	A3541	N/A	
KOMATSU	D57S-1		SEALED	1.496	8.661	7.48	50-007-003	25500	A3540	50-007-003	915060
KOMATSU	D58		SALT	1.377	7.13	6.89	50-007-004	25499	A3540	50-007-004	915060

WTC Machinery
100 Ton Field Press

KOMATSU	D58		SEALED	1.382	7.17	6.89	50-007-004	25499	A3540	50-007-004	915060
KOMATSU	D58E	BERCO	SEALED	1.496	8.661	6.906	50-007-003	25500	A3540	50-007-003	915059
KOMATSU	D58P-1	BERCO	SEALED	1.496	8.661	6.906	50-007-003	25500	A3540	50-007-003	915059
KOMATSU	D6	S/N 50001-50200	SALT	1.307	7.244	6.75	50-007-005	25499	A3540	50-007-005	915052
KOMATSU	D60		SEALED	1.76	9.433	8	50-007-002	25547	A3541	50-007-002	915084
KOMATSU	D60		SALT	1.75	9.433	8	50-007-002	25547	A3541	50-007-002	915084
KOMATSU	D60-6		SEALED	1.752	9.26	8	50-007-002	25547	A3541	50-007-002	915062
KOMATSU	D60A	BERCO NON-OEM	SEALED	1.756	9.449	7.984	50-007-002	25547	A3541	50-007-002	915116
KOMATSU	D60-A		RECESSED	1.488	8.583	7.48	50-007-003	25500	A3540	50-007-003	915056
KOMATSU	D61		SALT	1.496	8.897	7.48	50-007-003	25500	A3540	50-007-003	915060
KOMATSU	D61E		SALT	1.496	8.897	7.48	50-007-003	25500	A3540	50-007-003	915060
KOMATSU	D61EX		SALT	1.496	8.897	7.48	50-007-003	25500	A3540	50-007-003	915060
KOMATSU	D61P		SALT	1.496	8.897	7.48	50-007-003	25500	A3540	50-007-003	915060
KOMATSU	D61PX		SALT	1.496	8.897	7.48	50-007-003	25500	A3540	50-007-003	915060
KOMATSU	D61PX-12		SALT	1.496	8.897	7.48	50-007-003	25500	A3540	50-007-003	915060
KOMATSU	D63E		SALT	1.377	7.13	6.89	50-007-004	25499	A3540	50-007-004	915060
KOMATSU	D63E		SEALED	1.382	7.17	6.89	50-007-004	25499	A3540	50-007-004	915060
KOMATSU	D65		SEALED	1.76	9.433	8	50-007-002	25547	A3541	50-007-002	915084
KOMATSU	D65		SALT	1.75	9.433	8	50-007-002	25547	A3541	50-007-002	915084

WTC Machinery
100 Ton Field Press

KOMATSU	D65-6	S/N 34001 & UP	SALT	1.7559	9.5275	8	50-007-002	25547	A3541	50-007-002	915097
KOMATSU	D65A	BERCO NON-OEM	SEALED	1.756	9.449	7.984	50-007-002	25547	A3541	50-007-002	915116
KOMATSU	D65A		SEALED	1.76	9.433	8	50-007-002	25547	A3541	50-007-002	915084
KOMATSU	D65E		SEALED	1.76	9.433	8	50-007-002	25547	A3541	50-007-002	915084
KOMATSU	D65EX-12		SALT	1.75	9.433	8	50-007-002	25547	A3541	50-007-002	915084
KOMATSU	D65EX-15		SALT	1.75	9.433	8	50-007-002	25547	A3541	50-007-002	915084
KOMATSU	D65P-6	S/N 20006 & UP	SEALED	1.76	9.433	8	50-007-002	25547	A3541	50-007-002	915084
KOMATSU	D65PX		SALT	1.75	9.433	8	50-007-002	25547	A3541	50-007-002	915084
KOMATSU	D65PX-12		SALT	1.75	9.433	8	50-007-002	25547	A3541	50-007-002	915084
KOMATSU	D65PX-15		SALT	1.75	9.433	8	50-007-002	25547	A3541	50-007-002	915084
KOMATSU	D66		SEALED	1.76	9.433	8	50-007-002	25547	A3541	50-007-002	915084
KOMATSU	D66		SALT	1.7559	9.5275	8	50-007-002	25547	A3541	50-007-002	915097
KOMATSU	D68		SEALED	1.76	9.433	8	50-007-002	25547	A3541	50-007-002	915084
KOMATSU	D68		SALT	1.7559	9.5275	8	50-007-002	25547	A3541	50-007-002	915097
KOMATSU	D75		SEALED	1.8425	10	8.5039	50-007-002	25551	A3541	50-007-002	915096
KOMATSU	D75		SALT	1.8503	10	8.5039	50-007-002	25551	A3541	50-007-002	915096
KOMATSU	D75-S		SEALED	1.85	9.842	8.504	50-007-002	25551	A3541	50-007-002	915015
KOMATSU	D80		SEALED	1.8425	10	8.5039	50-007-002	25551	A3541	50-007-002	915096
KOMATSU	D80		SALT	1.8503	10	8.5039	50-007-002	25551	A3541	50-007-002	915096

WTC Machinery
100 Ton Field Press

KOMATSU	D80-7		SEALED	1.752	9.842	8	50-007-002	25547	A3541	50-007-002	915013
KOMATSU	D80-8		SEALED	1.752	9.842	8	50-007-002	25547	A3541	50-007-002	915013
KOMATSU	D85		SEALED	1.771	9.842	8.504	50-007-002	25551	A3541	50-007-002	915085
KOMATSU	D85		SALT	1.8503	10	8.5039	50-007-002	25551	A3541	50-007-002	915096
KOMATSU	D85-18	S/N 26514 & UP	SALT	1.8503	10	8.5039	50-007-002	25551	A3541	50-007-002	915096
KOMATSU	D85-18	S/N 26513 & DN	SEALED	1.85	10	8.5	50-007-002	25551	A3541	50-007-002	915232
KOMATSU	D85A		SEALED	1.771	9.842	8.504	50-007-002	25551	A3541	50-007-002	915085
KOMATSU	D85A		SEALED	1.8425	10	8.5039	50-007-002	25551	A3541	50-007-002	915096
KOMATSU	D85A-12		SEALED	1.85	9.842	8.504	50-007-002	25551	A3541	50-007-002	915015
KOMATSU	D85E		SEALED	1.8425	10	8.5039	50-007-002	25551	A3541	50-007-002	915096
KOMATSU	D85E-12	S/N 10001 & UP	SEALED	1.771	9.842	8.504	50-007-002	25551	A3541	50-007-002	915085
KOMATSU	D85E-12		SEALED	1.771	9.842	8.504	50-007-002	25551	A3541	50-007-002	915085
KOMATSU	D85EX-15		SALT	1.8503	10	8.5039	50-007-002	25551	A3541	50-007-002	915096
KOMATSU	D85P-18		SEALED	1.8425	10	8.5039	50-007-002	25551	A3541	50-007-002	915096
KOMATSU	D85PX		SALT	1.8503	10	8.5039	50-007-002	25551	A3541	50-007-002	915096
KOMATSU	D85PX-15		SALT	1.8503	10	8.5039	50-007-002	25551	A3541	50-007-002	915096
KOMATSU	D95		SALT	1.8503	10	8.5039	50-007-002	25551	A3541	50-007-002	915096
KOMATSU	D95		SEALED	1.8425	10	8.5039	50-007-002	25551	A3541	50-007-002	915096
KOMATSU	D95-S		SEALED	1.772	10	8.5	50-007-002	25551	A3541	50-007-002	915232

WTC Machinery
100 Ton Field Press

KOMATSU	PC100		UNSEALED	1.18	6.69	6.06	50-007-006	25498	A3540	50-007-006	915069
KOMATSU	PC100	PITCH ALSO 6.89	SEALED	1.181	6.811	6.063	50-007-006	25498	A3540	50-007-006	915126
KOMATSU	PC100		SEALED	1.18	6.81	6.89	50-007-006	25498	A3540	50-007-006	915161
KOMATSU	PC1000		SEALED	2.244	12.614	10.25	50-007-001	25553	A3541	N/A	915063
KOMATSU	PC1000-1		SALT	2.24	12.61	10.25	50-007-001	25553	A3541	N/A	915063
KOMATSU	PC1000S E-1		SALT	2.24	12.61	10.25	50-007-001	25553	A3541	N/A	915063
KOMATSU	PC100-1		SEALED	1.181	6.535	6.062	50-007-006	25498	A3540	50-007-006	915110
KOMATSU	PC100-2		SEALED	1.181	6.535	6.062	50-007-006	25498	A3540	50-007-006	915110
KOMATSU	PC100-3		SEALED	1.181	6.535	6.062	50-007-006	25498	A3540	50-007-006	915110
KOMATSU	PC100-6		SEALED	1.18	6.81	6.89	50-007-006	25498	A3540	50-007-006	915161
KOMATSU	PC100L-6		SEALED	1.49	8.66	7.49	50-007-003	25500	A3540	50-007-003	915060
KOMATSU	PC1100-6		DRY TRACK	2.36	12.77	11.03	50-007-001	25553	A3541	N/A	915131
KOMATSU	PC1100L C-6		DRY TRACK	2.36	12.77	11.03	50-007-001	25553	A3541	N/A	915131
KOMATSU	PC1100S P-6		DRY TRACK	2.36	12.77	11.03	50-007-001	25553	A3541	N/A	915131
KOMATSU	PC120		SEALED	1.18	6.81	6.89	50-007-006	25498	A3540	50-007-006	915161
KOMATSU	PC120	PITCH ALSO 6.89	SEALED	1.181	6.811	6.063	50-007-006	25498	A3540	50-007-006	915126
KOMATSU	PC120-1		SEALED	1.181	6.535	6.062	50-007-006	25498	A3540	50-007-006	915110
KOMATSU	PC120-2		SEALED	1.181	6.535	6.062	50-007-006	25498	A3540	50-007-006	915110
KOMATSU	PC120-3		SEALED	1.181	6.535	6.062	50-007-006	25498	A3540	50-007-006	915110

WTC Machinery
100 Ton Field Press

KOMATSU	PC120-6			1.181	6.811	6.9	50-007-006	25498	A3540	50-007-006	915231
KOMATSU	PC120-6			1.181	6.811	6.89	50-007-006	25498	A3540	50-007-006	915126
KOMATSU	PC120LC-6		SEALED	1.18	6.81	6.89	50-007-006	25498	A3540	50-007-006	915161
KOMATSU	PC1250		DRY TRACK	2.36	12.77	11.03	50-007-001	25553	A3541	N/A	915131
KOMATSU	PC1250-7		DRY TRACK	2.36	12.77	11.03	50-007-001	25553	A3541	N/A	915131
KOMATSU	PC1250L C-7		DRY TRACK	2.36	12.77	11.03	50-007-001	25553	A3541	N/A	915131
KOMATSU	PC1250S P-7		DRY TRACK	2.36	12.77	11.03	50-007-001	25553	A3541	N/A	915131
KOMATSU	PC130-6		SEALED	1.18	6.81	6.89	50-007-006	25498	A3540	50-007-006	915161
KOMATSU	PC138		SEALED	1.18	6.81	6.89	50-007-006	25498	A3540	50-007-006	915161
KOMATSU	PC150		UNSEALED	1.499	8.66	6.89	50-007-003	25500	A3540	50-007-003	915122
KOMATSU	PC1600		SALT	2.76	13.78	12.51	50-007-001	25553	A3541	N/A	915107
KOMATSU	PC200		SEALED	1.496	8.661	7.48	50-007-003	25500	A3540	50-007-003	915060
KOMATSU	PC2000		SALT	2.76	13.78	12.51	50-007-001	25553	A3541	N/A	915107
KOMATSU	PC200-6		SEALED	1.496	8.661	7.48	50-007-003	25500	A3540	50-007-003	915060
KOMATSU	PC200-7		SEALED	1.496	8.661	7.48	50-007-003	25500	A3540	50-007-003	915060
KOMATSU	PC200-8		SEALED	1.496	8.661	7.48	50-007-003	25500	A3540	50-007-003	915060
KOMATSU	PC220		SEALED	1.496	8.661	7.48	50-007-003	25500	A3540	50-007-003	915060
KOMATSU	PC240LC-6		SEALED	1.496	8.661	7.48	50-007-003	25500	A3540	50-007-003	915060
KOMATSU	PC250LC-6		SEALED	1.75	9.52	8.5	50-007-002	25547	A3541	50-007-002	915159

WTC Machinery
100 Ton Field Press

KOMATSU	PC270LC-6		SEALED	1.75	9.52	8.5	50-007-002	25547	A3541	50-007-002	915159
KOMATSU	PC270LC-7		SEALED	1.75	9.52	8.5	50-007-002	25547	A3541	50-007-002	915159
KOMATSU	PC300	EXC	SALT	1.75	9.53	8	50-007-002	25547	A3541	50-007-002	915097
KOMATSU	PC300	EXC	SEALED	1.76	9.53	8	50-007-002	25547	A3541	50-007-002	915076
KOMATSU	PC300HD-6		SEALED	1.85	9.92	9	50-007-002	25551	A3541	50-007-002	915160
KOMATSU	PC300LC-6		SEALED	1.75	9.52	8.5	50-007-002	25547	A3541	50-007-002	915159
KOMATSU	PC300LC-7		SEALED	1.75	9.52	8.5	50-007-002	25547	A3541	50-007-002	915159
KOMATSU	PC-400 EX		SEALED	1.85	10	8.504	50-007-002	25551	A3541	50-007-002	915232
KOMATSU	PC400-3		SEALED	1.8425	10	8.5039	50-007-002	25551	A3541	50-007-002	915096
KOMATSU	PC400-5		SEALED	1.8425	10	8.5039	50-007-002	25551	A3541	50-007-002	915096
KOMATSU	PC400-6		SEALED	1.85	10	9	50-007-002	25551	A3541	50-007-002	915096
KOMATSU	PC400-6		SEALED	1.8425	10	8.5039	50-007-002	25551	A3541	50-007-002	915096
KOMATSU	PC400LC-7		SEALED	1.85	10	9	50-007-002	25551	A3541	50-007-002	915096
KOMATSU	PC400LC SE-7		SEALED	1.85	10	9	50-007-002	25551	A3541	50-007-002	915096
KOMATSU	PC450		SEALED	1.85	10	9	50-007-002	25551	A3541	50-007-002	915096
KOMATSU	PC60	EXC	SEALED	0.945	5.55	5.31	50-007-008	200281	A3539	50-007-008	915123
KOMATSU	PC600		SEALED	2.185	12.614	10.25	50-007-001	25501	A3541	50-007-001	915125
KOMATSU	PC600	EXC	SEALED	1.85	10	8.504	50-007-002	25551	A3541	50-007-002	915232
KOMATSU	PC600-6			1.92	11.41	9	50-007-002	25551	A3541	50-007-002	915177

WTC Machinery
100 Ton Field Press

KOMATSU	PC600-7			1.92	11.41	9	50-007-002	25551	A3541	50-007-002	915177
KOMATSU	PC600LC-6			1.92	11.41	9	50-007-002	25551	A3541	50-007-002	915177
KOMATSU	PC600LC-7			1.92	11.41	9	50-007-002	25551	A3541	50-007-002	915177
KOMATSU	PC650-5		SEALED	2.185	12.614	10.25	50-007-001	25501	A3541	50-007-001	915125
KOMATSU	PC700		SEALED	2.185	12.614	10.25	50-007-001	25501	A3541	50-007-001	915125
KOMATSU	PC710		SEALED	2.185	12.614	10.25	50-007-001	25501	A3541	50-007-001	915125
KOMATSU	PC750		DRY TRACK	2.2	12.61	10.25	50-007-001	25553	A3541	50-007-001	915125
KOMATSU	PC750SE-6		SEALED	2.185	12.614	10.25	50-007-001	25501	A3541	50-007-001	915125
KOMATSU	PC80	PITCH ALSO 6.89	SEALED	1.181	6.811	6.063	50-007-006	25498	A3540	50-007-006	915126
KOMATSU	PC800		SEALED	2.185	12.614	10.25	50-007-001	25501	A3541	50-007-001	915125
KOMATSU	PC80-1		SEALED	1.181	6.535	6.062	50-007-006	25498	A3540	50-007-006	915110
KOMATSU	PC80-3		SEALED	1.181	6.535	6.062	50-007-006	25498	A3540	50-007-006	915110
KUBOTA	KH170L	EXC	UNSEALED	0.994	5.51	5.31	50-007-006	200281	A3539	50-007-007	915040
LIEBHERR	631	MAY WORK	SALT	1.752	9.06	7.985	50-007-002	25547	A3541	50-007-002	915003
LIEBHERR	PR711		SALT	1.315	7.22	6.735	50-007-005	25499	A3540	50-007-005	915052
LIEBHERR	PR721		SALT	1.442	8.12	6.735	50-007-004	25500	A3540	50-007-004	915052
LIEBHERR	PR731		SALT	1.752	9.06	7.985	50-007-002	25547	A3541	50-007-002	915003
LIEBHERR	R912		SEALED	1.314	7	6.735	50-007-005	25499	A3540	50-007-005	915002
LIEBHERR	R922		SEALED	1.314	7	6.735	50-007-005	25499	A3540	50-007-005	915002

WTC Machinery
100 Ton Field Press

LIEBHERR	R932		SEALED	1.442	8.13	6.735	50-007-004	25500	A3540	50-007-004	915009
LINKBELT	LS2800		SEALED	1.442	8.13	6.735	50-007-004	25500	A3540	50-007-004	915009
LINKBELT	LS4800		SEALED	1.878	9.88	8.5	50-007-002	25551	A3541	50-007-002	915012
LINKBELT	LS5400		SEALED	1.878	9.88	8.5	50-007-002	25551	A3541	50-007-002	915012
LINKBELT	LS5800		SEALED	1.878	9.88	8.5	50-007-002	25551	A3541	50-007-002	915012
LINKBELT	LS6400		SEALED	2.003	11.44	9	50-007-001	25551	A3541	50-007-001	915001
LINKBELT	LS7400		SEALED	2.003	11.44	9	50-007-001	25551	A3541	50-007-001	915001
LINKBELT	LS7800		SEALED	1.442	8.13	6.735	50-007-004	25500	A3540	50-007-004	915009
LINKBELT	LS9800		SEALED	1.752	9.88	7.985	50-007-002	25547	A3541	50-007-002	915012
MASSEY-FERGUSON	MF200B		SEALED	1.063	5.75	5.512	50-007-006	200281	A3539	50-007-007	915004
MASSEY-FERGUSON	MF2244		RECESSED	0.984	5.42	5.512	50-007-006	200281	A3539	50-007-007	915057
MASSEY-FERGUSON	MF300		RECESSED	1.299	6.61	6.299	50-007-005	25499	A3540	50-007-005	915002
MASSEY-FERGUSON	MF300		SEALED	1.299	6.61	6.299	50-007-005	25499	A3540	50-007-005	915078
MASSEY-FERGUSON	MF400C		SEALED	1.38	7.01	6.69	50-007-004	25499	A3540	50-007-004	915078
MASSEY-FERGUSON	MF450		RECESSED	1.299	6.61	6.299	50-007-005	25499	A3540	50-007-005	915002
MASSEY-FERGUSON	MF500		RECESSED	1.378	7.17	6.69	50-007-004	25499	A3540	50-007-004	915080
MASSEY-FERGUSON	MF500B		SEALED	1.441	8.11	6.75	50-007-004	25500	A3540	50-007-004	915079
MASSEY-FERGUSON	MF600C		SEALED	1.752	8.66	7.98	50-007-002	25547	A3541	50-007-002	915081
MASSEY-FERGUSON	MFD400C		SEALED	1.38	7.01	6.69	50-007-004	25499	A3540	50-007-004	915078

WTC Machinery
100 Ton Field Press

MASSEY-FERGUSSON	MFD700C		SEALED	1.88	9.88	8.5	50-007-002	25551	A3541	50-007-002	915062
TEREX	82-20AA,		RECESSED	1.75	9.19	8	50-007-002	25547	A3541	50-007-002	915075
TEREX	82-30		RECESSED	1.75	9.19	8	50-007-002	25547	A3541	50-007-002	915075
TEREX	82-30AA		RECESSED	1.75	11.52	8	50-007-002	25547	A3541	50-007-002	915021
TEREX	82-30B		RECESSED	2	11.52	9	50-007-001	25551	A3541	50-007-001	915077
TEREX	82-30FA		RECESSED	1.75	11.52	8	50-007-002	25547	A3541	50-007-002	915021
TEREX	82-40AA		RECESSED	1.75	11.52	8	50-007-002	25547	A3541	50-007-002	915021
TEREX	82-40CA		RECESSED	1.75	11.52	8	50-007-002	25547	A3541	50-007-002	915021
TEREX	82-40DA		RECESSED	2	11.52	9	50-007-001	25551	A3541	50-007-001	915077
TEREX	82-50		RECESSED	2.38	12.38	10.312	50-007-001	25553	A3541	N/A	915063
TEREX	82-80DA		RECESSED	2	12.38	9	50-007-001	25551	A3541	50-007-001	915076
TEREX	TC-12		RECESSED	2	12.38	9	50-007-001	25551	A3541	50-007-001	915076
VOLVO	EC150LC			1.496	8.1875	7.5	50-007-003	25500	A3540	50-007-003	915234