

FP100LPG	Large Pin Group	Items 1-3, 17-19, 22, 29	1.84" to 2.56" (46.0 to 65.1 mm)
FP100MPG	Medium Pin Group	Items 3-6, 28, 13-16, 21	1.31" to 1.81" (33.3 to 46.0 mm)
FP100SPG	Small Pin Group	Items 6-9, 10-12, 20	0.63" to 1.31" (16.0 to 33.3 mm)
PART NO.	DESCRIPTION	ITEMS	PIN SIZE RANGE
BASIC PIN GROUPS			

27	See Tool Chart	Pin Assembly Tool
26*	50-008-002	Pin Adapter Holder
25*	50-008-001	Assembly Tool
23*	B2866	Cylinder Cam-Lock Adapter
ITEM	PART NO.	DESCRIPTION
ADAPTERS		

*NOTE: Items 23, 25 and 26 Included with the FP100

1	50-007-001	1.97"	50.0 mm	2.22"	56.3 mm
2	50-007-002	1.72"	43.6 mm	1.97"	50.0 mm
3	50-007-003	1.60"	40.7 mm	1.72"	43.6 mm
28	50-007-010	1.47"	37.3 mm	1.60"	40.7 mm
4	50-007-004	1.34"	34.1 mm	1.47"	37.3 mm
5	50-007-005	1.22"	30.9 mm	1.34"	34.1 mm
6	50-007-006	1.09"	27.7 mm	1.22"	30.9 mm
7	50-007-007	0.94"	23.8 mm	1.09"	27.7 mm
8	50-007-008	0.84"	21.4 mm	0.94"	23.8 mm
9	50-007-009	0.63"	15.9 mm	0.84"	21.4 mm
ITEM	PART NO.	INCH	MM	INCH	MM
		MIN. PIN DIA.		MAX. PIN DIA.	
PIN ADAPTERS					

For Disassembly, Pin Adapters hold Forcing Pins
For Re-assembly, Pin Adapters hold Track Pins

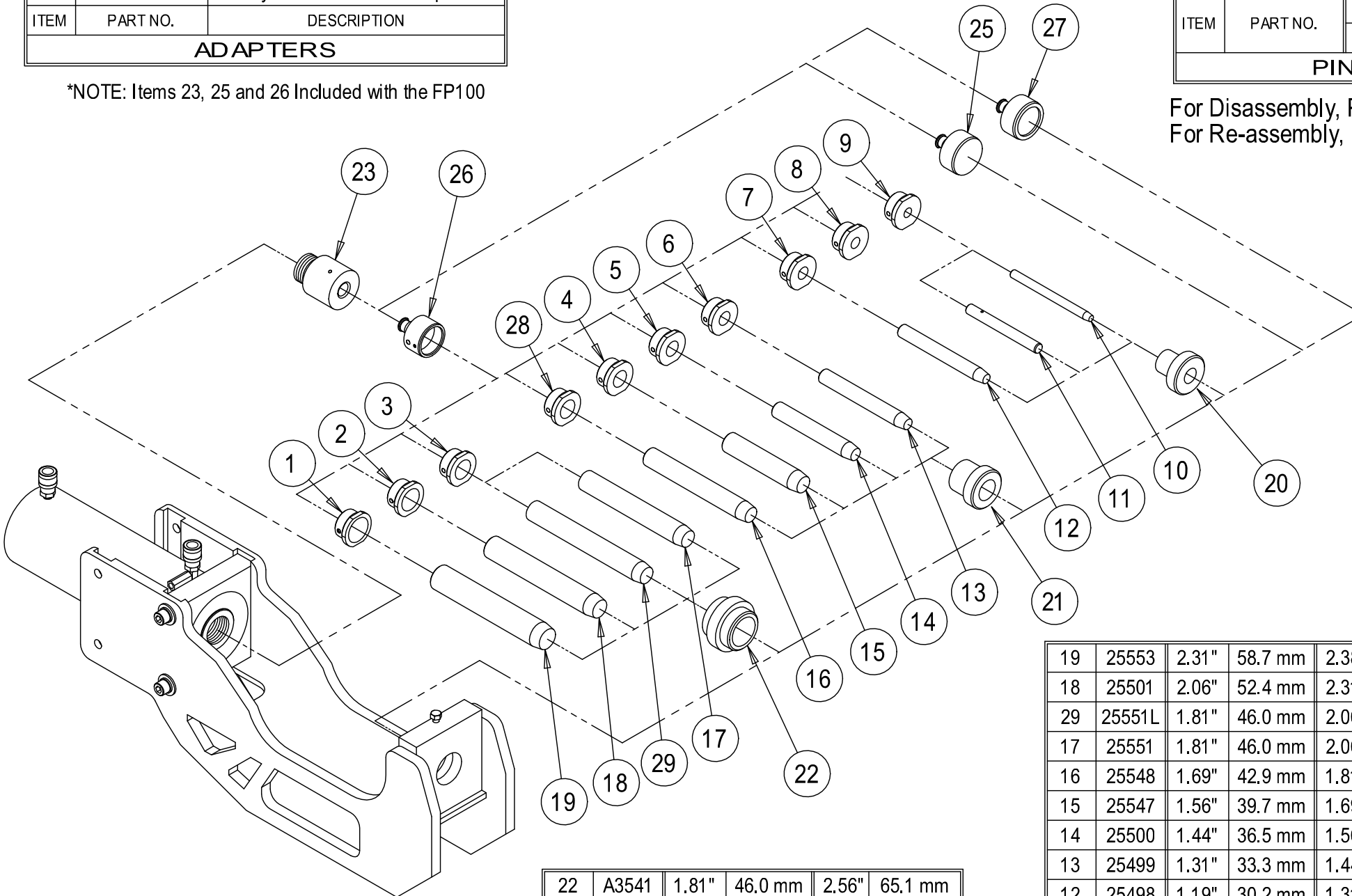

Cylinder moves to Back Position
When working Large Track

22	A3541	1.81"	46.0 mm	2.56"	65.1 mm
21	A3540	1.31"	33.3 mm	1.81"	46.0 mm
20	A3539	0.63"	16.0 mm	1.31"	33.3 mm
ITEM	PART NO.	INCH	MM	INCH	MM
		MIN. PIN DIA.		MAX. PIN DIA.	
BACKING BUSHINGS					

Backing Bushings Support the
Track Link for Disassembly and Assembly

19	25553	2.31"	58.7 mm	2.38"	60.3 mm	1	50-007-001
18	25501	2.06"	52.4 mm	2.31"	58.7 mm	2	50-007-002
29	25551L	1.81"	46.0 mm	2.06"	52.4 mm	3	50-007-003
17	25551	1.81"	46.0 mm	2.06"	52.4 mm		
16	25548	1.69"	42.9 mm	1.81"	46.0 mm	28	50-007-010
15	25547	1.56"	39.7 mm	1.69"	42.9 mm	4	50-007-004
14	25500	1.44"	36.5 mm	1.56"	39.7 mm	5	50-007-005
13	25499	1.31"	33.3 mm	1.44"	36.5 mm	6	50-007-006
12	25498	1.19"	30.2 mm	1.31"	33.3 mm	7	50-007-007
11	200281	0.94"	23.8 mm	1.19"	30.2 mm	8	50-007-008
10	25503	0.76"	19.4 mm	0.94"	23.8 mm	9	50-007-009
ITEM	PART NO.	INCH	MM	INCH	MM	ITEM	PART NO.
		MIN. PIN DIA.		MAX. PIN DIA.			
FORCING PINS							

For Disassembly, Forcing Pins push the Track Pin
For Assembly, Forcing Pins hold the Links Aligned

FP100 Tooling