



WTC MACHINERY Engineered to perform. Built to last.

WTC Machinery is a global leader in designing and building machinery and tooling for heavy equipment repair facilities.

FP250 Portable Pin Press

Overview

WTC Machinery's FP250 pin press has a similar design as our FP100 press, however, much larger with 250 tons of force to press the largest of dozer, excavator and feeder chain. This is an option designed specifically for situations where the MPP150 or MPP250 tie rod design will not work or for those operators who like the c-frame design. Using the same tooling as the MPP250 it is capable of service the same Caterpillar D11, Komatsu D475 tracks or pin diameters ranging from .87" (22,0mm) up to 3.55" (89,9mm).



The FP250 press is available without a hydraulic pump, or we provide several durable pumps to match shop or a service truck power. For safety during use, we also offer an optional pressure gauge, lifting sling (engineered specifically for use with this press) and a safety blanket (to protect from possible flying debris).

Due to the sheer size of this press a box is not an option. To protect your investment and keep everything together in one convenient spot WTC offers a custom travel skid for safe and secure storage and transportation of your FP250 press, pump and tooling.



FP250 on Travel Skid



FP250 vs FP100



W1222 LINDEN ROAD, IXONIA, WISCONSIN 53036 USA

Phone: 800-248-8405 or 262-567-3993 • Fax: 262-567-4307 www.wtcmachinery.com

MANUFACTURERS/BENEFICIARY'S WARRANTY CERTIFICATE WTC MACHINERY, LLC WARRANTY

WTC MACHINERY, LLC warrants its products to be free from defects in material and workmanship under normal use and service for a period of twelve (12) months after date of shipment. WTC MACHINERY, LLC undertakes to be responsible for any defect that may arise due to faulty raw materials, design, workmanship and defective parts and to replace them without extra cost. Freight charges are the customer's responsibility. Our warranty is not transferable.

WTC MACHINERY, LLC shall have the option of requiring the return of all parts claimed defective. Parts proved to be defective, due to defect in workmanship and/or material, shall be either repaired or replaced free of charge, F.O.B. our designated factory. All parts warranty claims are subject to inspection by WTC MACHINERY, LLC and acceptance at the factory

Our warranty does not obligate us to bear the cost of labor or transportation charges in connection with the replacement or repair of defective parts and the removal and/or remounting of the parts repaired or replaced under this warranty, unless specifically authorized in writing by WTC MACHINERY, LLC. All parts returned to the factory must be shipped freight prepaid; no collect freight will be accepted by the factory. Forms authorizing such returns for inspection must accompany all returns.

This warranty shall not apply to products not manufactured by WTC MACHINERY, LLC.

Outside purchased equipment and accessories (not of WTC manufacture) are warranted only to the extent of the original equipment manufacturer's warranty and subject to their allowance to WTC MACHINERY, LLC. In this respect, our warranty obligations must conform and be limited to the warranty extended to WTC MACHINERY, LLC by its suppliers as extended to the customer.

We shall, in no event, be liable for consequential damages or contingent liability arising out of the failure of any unit or part to operate properly, or that is subject to:

- Ordinary operating wear, abuse, misuse, or overloading;
- Repairs or alterations by parties other than WTC MACHINERY, LLC;
- The use of improper fluids, contaminated fluids or improper filtering;
- The use of improper voltage hookup in the electrical connections of any equipment;
- Negligence, accident or damages due to deterioration during periods of storage by the purchaser prior to installation and operation;
- Damages occurred in shipment after leaving factory en route to customers' delivery point, as title to equipment passes to customer when loaded onboard for shipment, f.o.b. factory, and customer must place his own claim against damaged goods directly to the shipping company and not against WTC MACHINERY, LLC, its factory, or any of its personnel.
- Damages due to circumstances beyond the control of WTC MACHINERY, LLC and in connection with fulfilling any obligation under this warranty.

To the maximum extent permitted by applicable law, in no event shall WTC Machinery, LLC be liable for indirect, special, incidental or consequential damages resulting from personal injury, loss of business profits or business interruption from the use of its products, or from the inability to use its products.

This warranty is exclusive and is in lieu of all other expressed and implied warranties, including but not limited to implied warranties or merchantability and fitness for a particular purpose. WTC MACHINERY, LLC shall not be subject to any other obligations or liabilities whatsoever with respect to equipment manufactured or supplied by WTC MACHINERY, LLC, or services rendered to it.



SECTION 2 – FP250 Field Press Specifications

DIMENSIONS

Weight (less Hydraulic Power Supply) 1,850 lbs (840 kg)
Width 19.8" (502 mm)
Height 23.0" (584 mm)
Length..... Back Position – 71.5" (1820 mm)
 Front Position – 61.5" (1562 mm)
 Stowed - 48.5" (1232 mm)

ENVIRONMENTAL

Operating Temperature Range - -40 to 100 °F (-40 to 38 °C) (See page 6 for hydraulic oil recommendations)
 Storage Conditions - 0 to 150 °F (-18 to 65 °C) Non-condensing Moisture

PRESSING CAPACITY

250 Short Tons (227,3 tonnes)

HYDRAULIC CYLINDER STROKE

Stroke – 18.0" (457 mm) Bore – 8.00" (203 mm)

THROAT DIMENSIONS

Width – 18.7" (475 mm) Depth – 5.2" (133 mm)

TRACK MODELS

Up to Caterpillar D11, Komatsu D475, and comparable Bulldozer and Excavator Tracks

HYDRAULIC POWER SUPPLIES

Maximum Pressure (all units)..... 10,000 p.s.i. (690 bar)

	Compressed Air	115V 60 Hz Electric	220V 50 Hz Electric*
FP250 Model	FP250A	FP250E	FP250-220-CE
Reservoir Capacity	5 gal (18,9 l)	5 gal (18,9 l)	5 gal (18,9 l)
Flow @ 150 psi (10,3 bar)	500 in ³ /min (8,2 lpm)	310 in ³ /min (5,1 lpm)	700 in ³ /min (11,5 lpm)
Flow @ 10000 psi (690 bar)	100 in ³ /min (1,6 lpm)	37 in ³ /min (0,6 lpm)	60 in ³ /min (1,0 lpm)
Power	4 Hp (3,0 kW)	1-1/2 Hp (1,1 kW)	1-3/4 Hp (1,3 kW)
Power Supply	62 SCFM @ 100 psi 1,8 m ³ /min @ 6,9 bar	10 A @ 115 V 60Hz	11 A @ 220 V 50 Hz
Width	11.7" (0,30 m)	11.7" (0,30 m)	19.7" (0,50 m)
Length	25.8" (0,66 m)	25.8" (0,66 m)	24.0" (0,61 m)
Height	12.6" (0,32 m)	18.3" (0,47 m)	18.3" (0,47 m)
Dry Weight	44 lb (20 kg)	108 lb (49 kg)	109 lb (50 kg)

* - Also available: 5.0 Amps, 220V 60Hz, 1 Phase (FP250-220)
 5.0 Amps, 220V 50Hz, 1 Phase Non-CE Mark (FP250-220-50)

SPECIFICATIONS SUBJECT TO CHANGE WITHOUT NOTICE



PART IDENTIFICATION

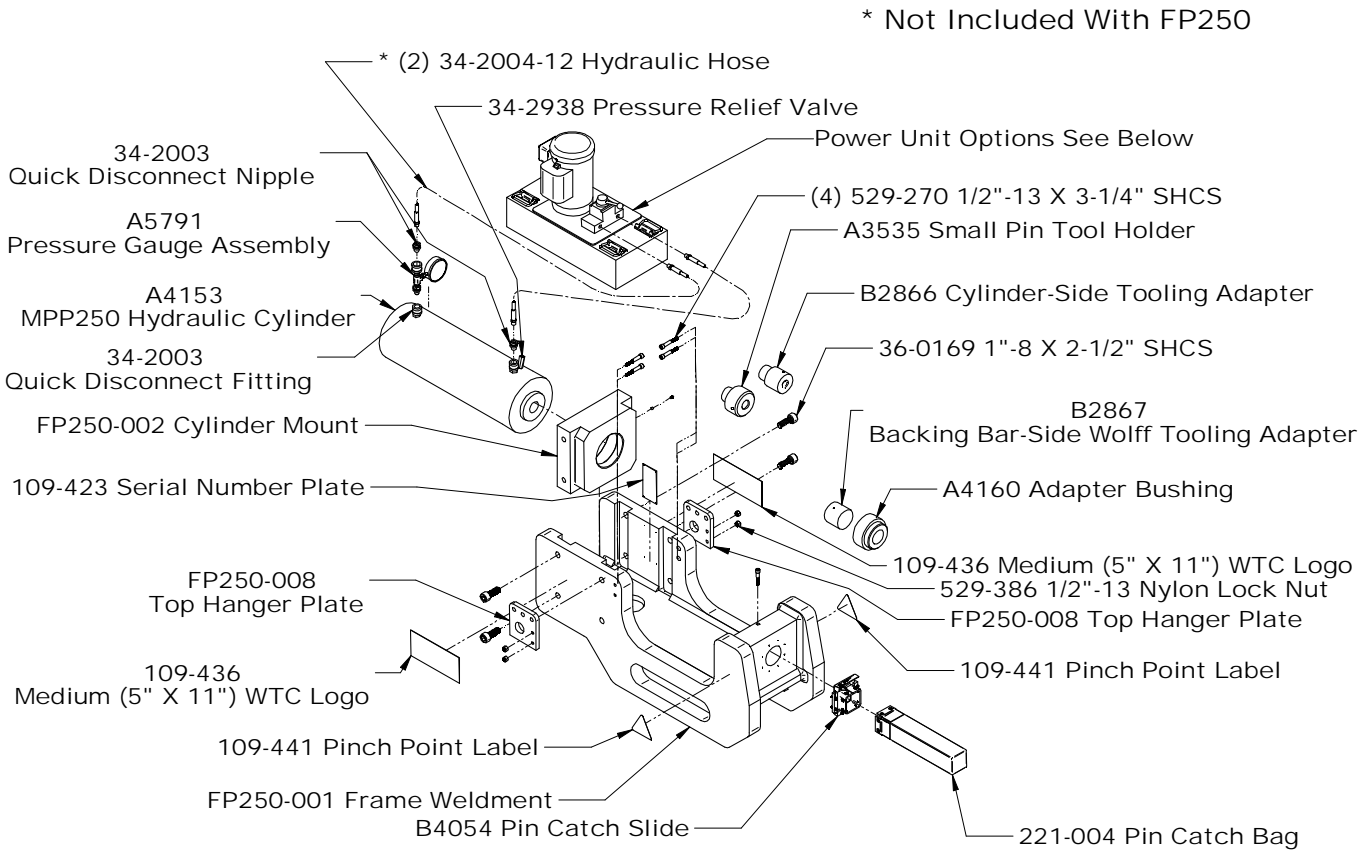

FP250 Field Press General Arrangement

MODEL LISTING

FP250***	FP250 with Cylinder, less Hydraulic Parts (Pump, Hoses and Fittings) –Customer-supplied Pump Base and Hydraulic Hoses
FP250E	FP250 with 115 V Electric Powered Pump – Includes 34-3057 Electric Pump 115V 60 Hz
FP250-220	FP250 with 220V 60Hz Powered Electric Pump (North America) – Includes 34-3061 Electric Pump 220V 50 Hz
FP250-220-50	FP250 with 220V 50Hz Powered Electric Pump (Outside Europe and North America) – Includes 34-3059 Electric Pump 220V 50 Hz
FP250-220-CE***	FP250 with CE-Certified 220V 50Hz Powered Electric Pump (European Union) – Includes 34-2074 Electric Pump 220V 50 Hz CE-Marked
FP250A	FP250 with Compressed Air Powered Pump – Includes 34-3003MPP Air-Powered Pump

*** Certified 

SECTION 6 –Tooling

! WARNING!

*Only trained personnel familiar with operation should use the FP250.
Always make sure the FP250 tools are in good condition and aligned and centered with track components before pressing.
Always wear eye protection when operating the FP250.*

! CAUTION!

*Track condition affects the disassembly force, and some track models may exceed the capacity of the FP250.
It is the operator's responsibility to determine whether the FP250 is adequate for a particular track.*

The Tool Chart (starting on page 13) show the correct tooling for most crawler track models. For track models not listed, the drawing (below) shows the size ranges for Forcing Pins, Pin Adapters and Backing Bushing. See www.WTCmachinery.com for updated to tool charts

Forcing Pins		
Item	Part Number	Description
1	B3606	Long 2.677 Thread-in Pin
2	B3605	Short 2.677 Thread-in Pin
3	B3632	Long 2.375 Thread-in Pin
4	B3631	Short 2.375 Thread-in Pin
5	B3607	Long 2.000 Thread-in Pin
6	B3608	Short 2.000 Thread-in Pin
7	B3815	1.750 Thread-in Pin Tool
8	B3635	1.250 Thread-in Pin Tool
9	A3537	Medium Pin Tool
10	A3536	Small Pin Tool

Backing Bushings		
Item	Part Number	Description
11	A4157	Extra-Large Bushing
12	A6212	Large Bushing
13	A3541	Large Backing Bushing
14	A3540	Medium Backing Bushing
15	A3539	Small Backing Bushing

Pin Adapters		
Item	Part Number	Min/Max Pin Dia.
16	50-007-001	1.97" to 2.22" (50,0 to 56,3 mm)
17	50-007-002	1.72" to 1.97" (43,6 to 50,0 mm)
18	50-007-003	1.60" to 1.72" (40,7 to 43,6 mm)
19	50-007-004	1.34" to 1.47" (34,1 to 37,3 mm)
20	50-007-005	1.22" to 1.34" (30,9 to 34,1 mm)
21	50-007-006	1.09" to 1.22" (27,7 to 30,9 mm)
22	50-007-007	0.94" to 1.09" (23,8 to 27,7 mm)
23	50-007-008	0.84" to 0.94" (21,4 to 23,8 mm)
24	50-007-009	0.63" to 0.84" (15,9 to 21,4 mm)
25	50-007-010	1.47" to 1.60" (37,3 to 40,7 mm)

Misc. Adapters		
Item	Part Number	Description
26	*A3535	Small Pin Tool Holder
27	*B2866	Cylinder-Side Tooling
28	50-008-002	Pin Adapter Holder
29	See Tooling Chart	See Tooling Chart
31	*B2867	Backing Bar-Side
32	*50-008-001	Pin Assembly Tool

* Items Included With FP250

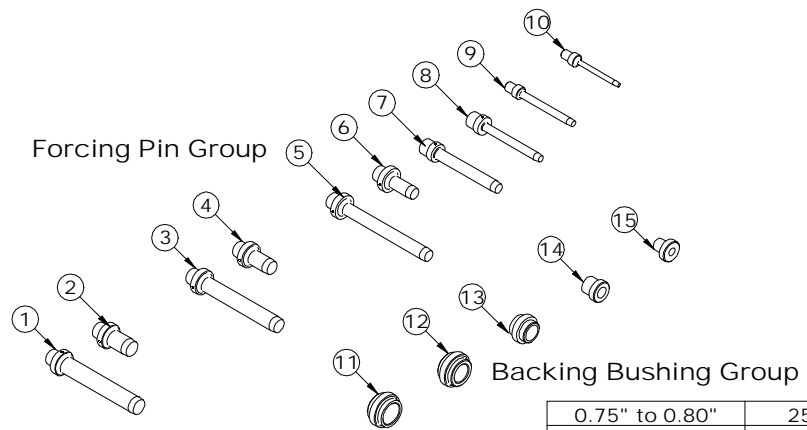

0.75" to 0.80"	25503
0.80" to 0.86"	200281-001
0.86" to 1.17"	200281
1.17" to 1.30"	25498
1.30" to 1.42"	25499
1.42" to 1.55"	25500
1.55" to 1.67"	25547
1.67" to 1.80"	25548
1.80" to 1.98"	25551
1.98" to 2.25"	25501
More than 2.25"	25553
Pin Diameter	Part No.
Optional Guide Pins (Not Shown)	

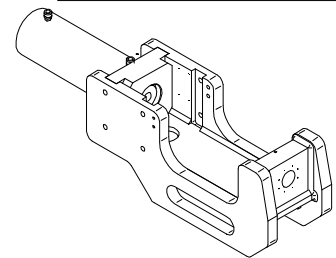
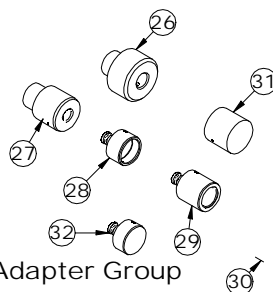
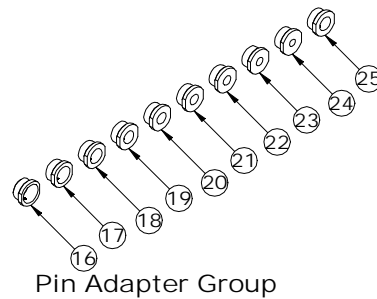

FP250 Tooling