

FP100LPG	Large Pin Group	Items 1-3, 17-19, 22, 29	1.84" to 2.56" (46,0 to 65,1 mm)
FP100MPG	Medium Pin Group	Items 3-6, 28, 13-16, 21	1.31" to 1.81" (33,3 to 46,0 mm)
FP100SPG	Small Pin Group	Items 6-9, 10-12, 20	0.63" to 1.31" (16,0 to 33,3 mm)
PART NO.	DESCRIPTION	ITEMS	PIN SIZE RANGE

**BASIC PIN GROUPS**

30*	529-522	Pin Locking Bolt
27	See Tool Chart	Pin Assembly Tool
26*	50-008-002	Pin Adapter Holder
25*	50-008-001	Assembly Tool
23*	B2866	Cylinder Cam-Lock Adapter
ITEM	PART NO.	DESCRIPTION

**ADAPTERS**

\*NOTE: Items 23, 25 and 26 Included with the FP100

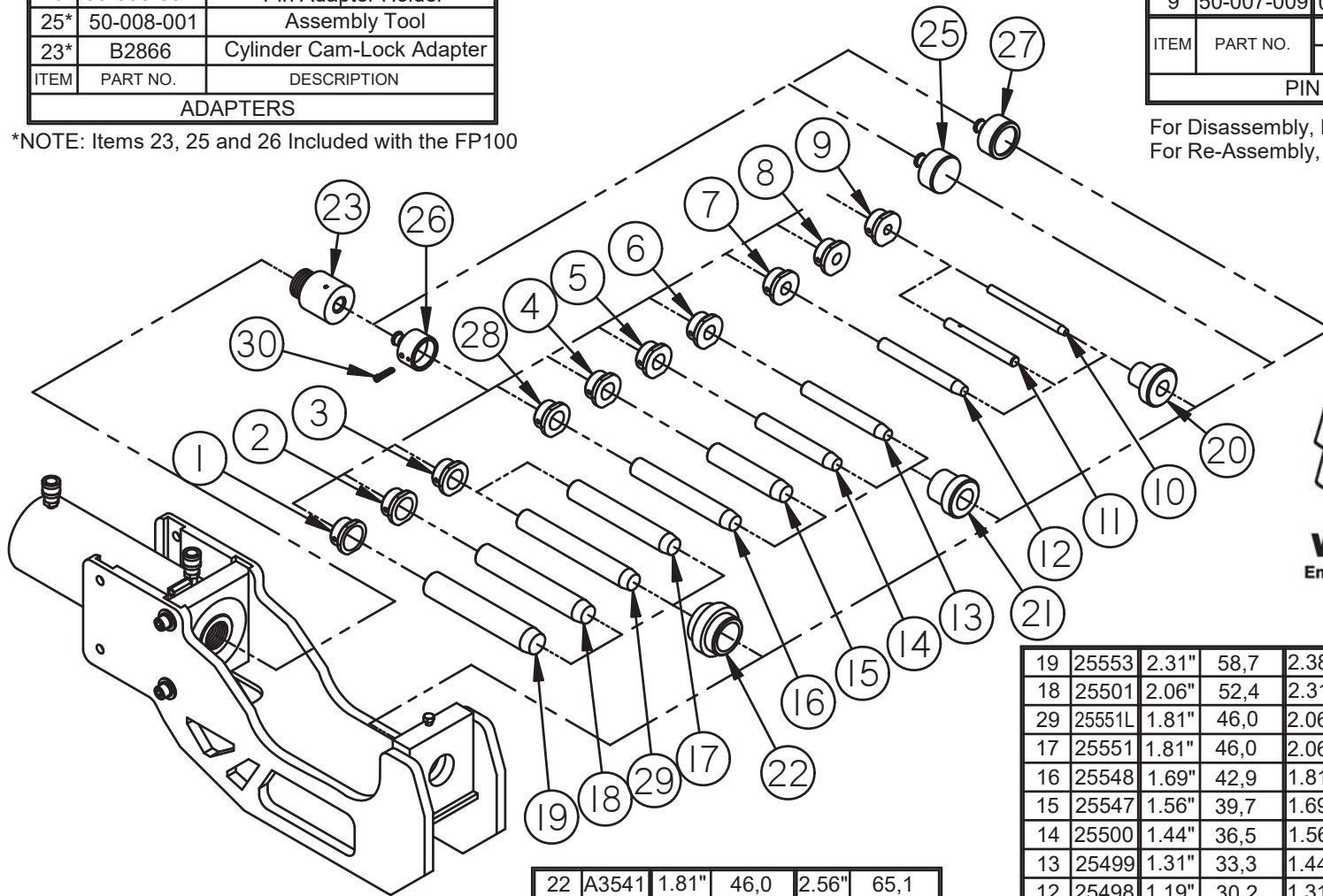

Move Cylinder to Back Position  
When working Large Track

22	A3541	1.81"	46,0	2.56"	65,1
21	A3540	1.31"	33,3	1.81"	46,0
20	A3539	0.63"	16,0	1.31"	33,3
ITEM	PART NO.	MIN. PIN DIA.	MAX. PIN DIA.	MIN. PIN DIA.	MAX. PIN DIA.

**BACKING BUSHINGS**

Backing Bushings Support the Track Chain  
for Disassembly and Re-Assembly

1	50-007-001	1.97"	50,0	2.22"	56,3
2	50-007-002	1.72"	43,6	1.97"	50,0
3	50-007-003	1.60"	40,7	1.72"	43,6
28	50-007-010	1.47"	37,3	1.60"	40,7
4	50-007-004	1.34"	34,1	1.47"	37,3
5	50-007-005	1.22"	30,9	1.34"	34,1
6	50-007-006	1.09"	27,7	1.22"	30,9
7	50-007-007	0.94"	23,8	1.09"	27,7
8	50-007-008	0.84"	21,4	0.94"	23,8
9	50-007-009	0.63"	15,9	0.84"	21,4
ITEM	PART NO.	MIN. PIN DIA.	MAX. PIN DIA.	MIN. PIN DIA.	MAX. PIN DIA.

**PIN ADAPTERS**

For Disassembly, Pin Adapters hold Forcing Pins  
For Re-Assembly, Pin Holders hold Track Pins



**WTC MACHINERY**  
Engineered to perform. Built to last.

19	25553	2.31"	58,7	2.38"	60,3	1	50-007-001
18	25501	2.06"	52,4	2.31"	58,7	2	50-007-002
29	25551L	1.81"	46,0	2.06"	52,4	3	50-007-003
17	25551	1.81"	46,0	2.06"	52,4		
16	25548	1.69"	42,9	1.81"	46,0	28	50-007-010
15	25547	1.56"	39,7	1.69"	42,9	4	50-007-004
14	25500	1.44"	36,5	1.56"	39,7	5	50-007-005
13	25499	1.31"	33,3	1.44"	36,5	6	50-007-006
12	25498	1.19"	30,2	1.31"	33,3	7	50-007-007
11	200281	0.94"	23,8	1.19"	30,2	8	50-007-008
10	25503	0.76"	19,4	0.94"	23,8	9	50-007-009
ITEM	PART NO.	MIN. PIN DIA.	MAX. PIN DIA.	MIN. PIN DIA.	MAX. PIN DIA.	ITEM	PART NO.

**FORCING PINS**

For Disassembly, Forcing Pins push the Track Pin  
For Re-Assembly, Forcing Pins hold the Links Aligned

# FP100 Tooling